

DMC 550S - PLYWOOD

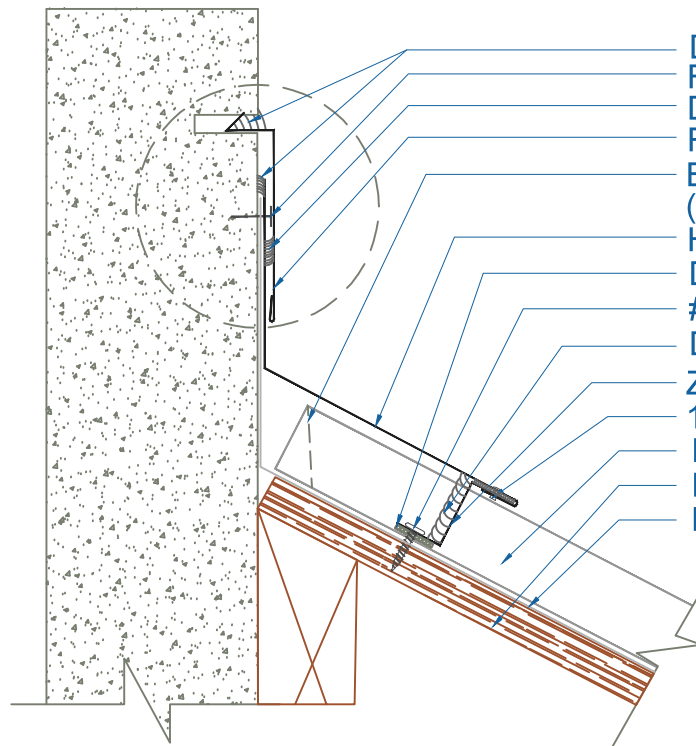

DREXEL APPROVED TUBE SEALANT
FASTENERS (BY OTHERS)
DREXEL APPROVED TUBE SEALANT
REGLET FLASHING
BOX END OF PANEL
(SEE ZEE CLOSURE OPTIONS DETAIL)
HEADWALL FLASHING
D.B. TAPE SEALANT
#10 - 13 x 1" PHW (5 PER PANEL)
DREXEL APPROVED TUBE SEALANT
Z-CLOSURE FLASHING
1/8" - #43 POP RIVET (18" o.c.)
DMC 550S PANEL
PLYWOOD SUBSTRATE (1/2" MIN.)
METSHIELD UNDERLAYMENT

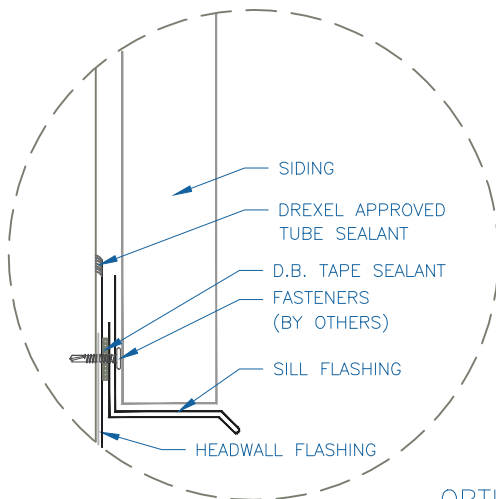

OPTION 1

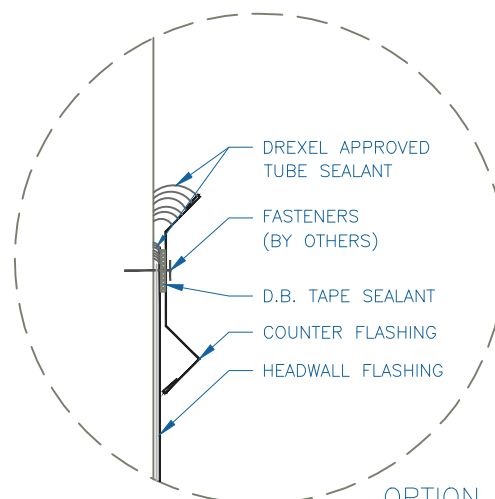

OPTION 2

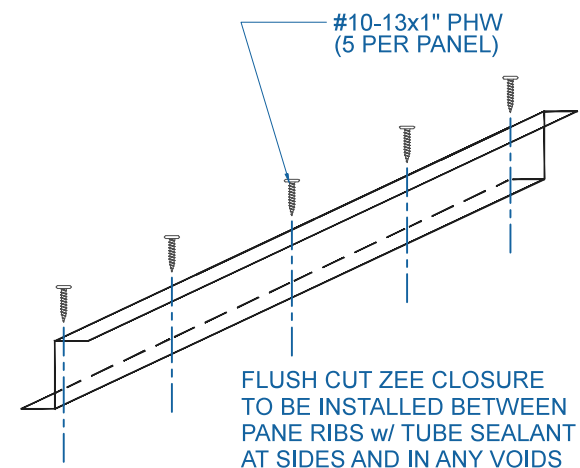

EFFECTIVE DATE: 08-14-2013
SUBJECT TO CHANGE WITHOUT NOTICE

HEADWALL

SCALE: 3" = 1'-0"

DrexelMetals
Roofing Systems + Custom Fabrication

