

DMC 100NS - PLYWOOD

ZOOMED IN VIEW

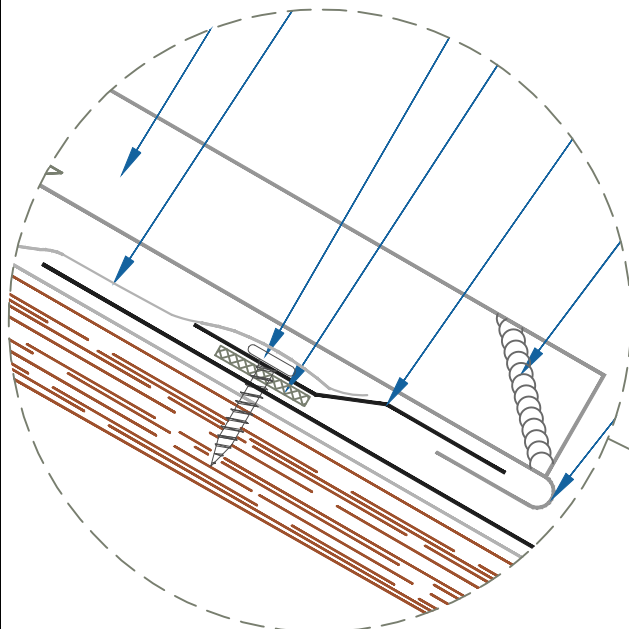

NTS

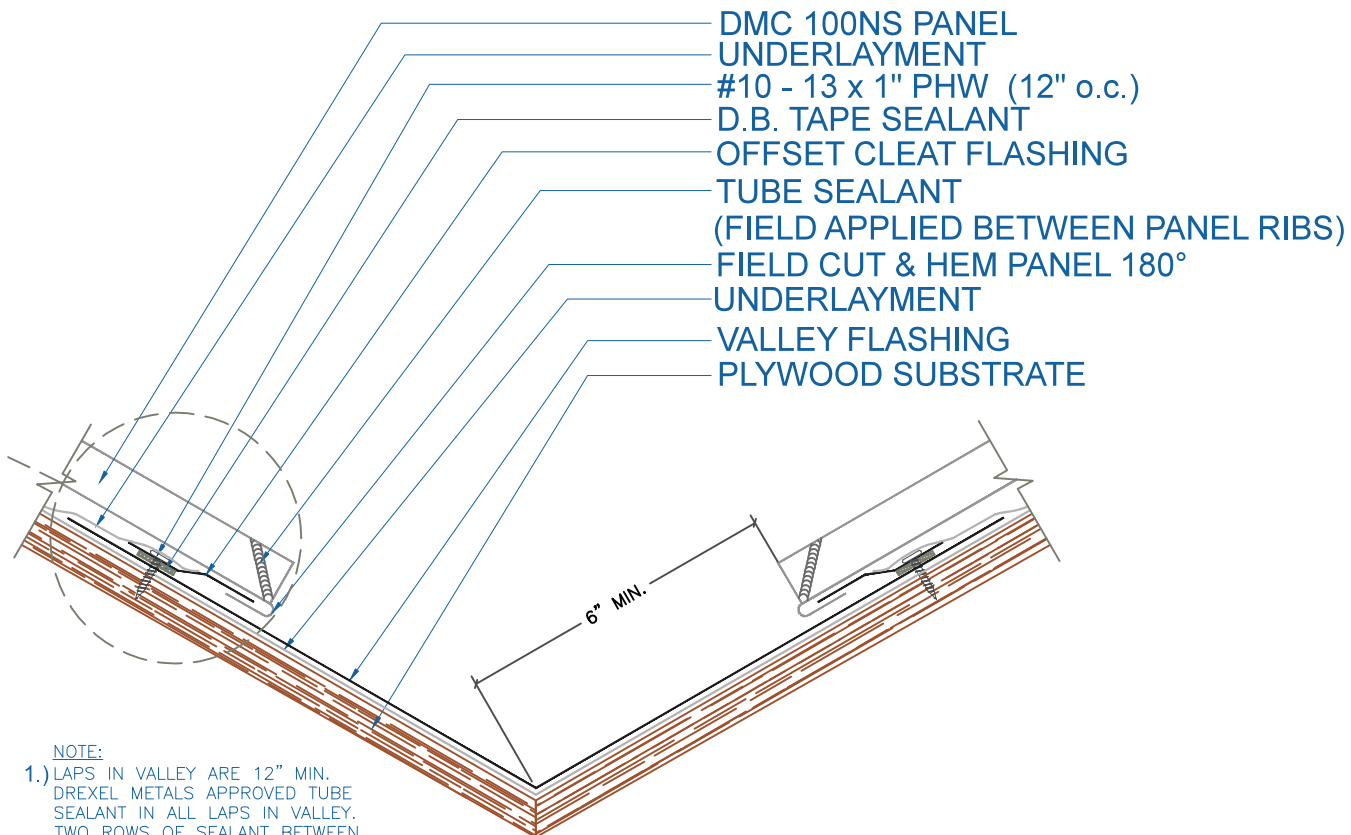

NOTE:

- 1.) LAPS IN VALLEY ARE 12" MIN.
DREXEL METALS APPROVED TUBE
SEALANT IN ALL LAPS IN VALLEY.
TWO ROWS OF SEALANT BETWEEN
VALLEY LAPS, 4" UP FROM LAP.
- 2.) LARGE ROOF AREAS MAY REQUIRE
A LARGER GAP BETWEEN PANEL
AND DIVERTER TO ALLOW FOR
STORM WATER RUN OFF.

VALLEY

SCALE: 3" = 1'-0"

EFFECTIVE DATE: 9-1-2013

DrexelMetals
Roofing Systems + Custom Fabrication

