

DEFEND-R CI PLY
PUNCHED INLINE WINDOW SILL DETAIL
DEFEND-R CI POLYISO NON-COMPOSITE
CONTINUOUS INSULATION UNDER WRB NO SHEATHING
MASONRY CLADDING

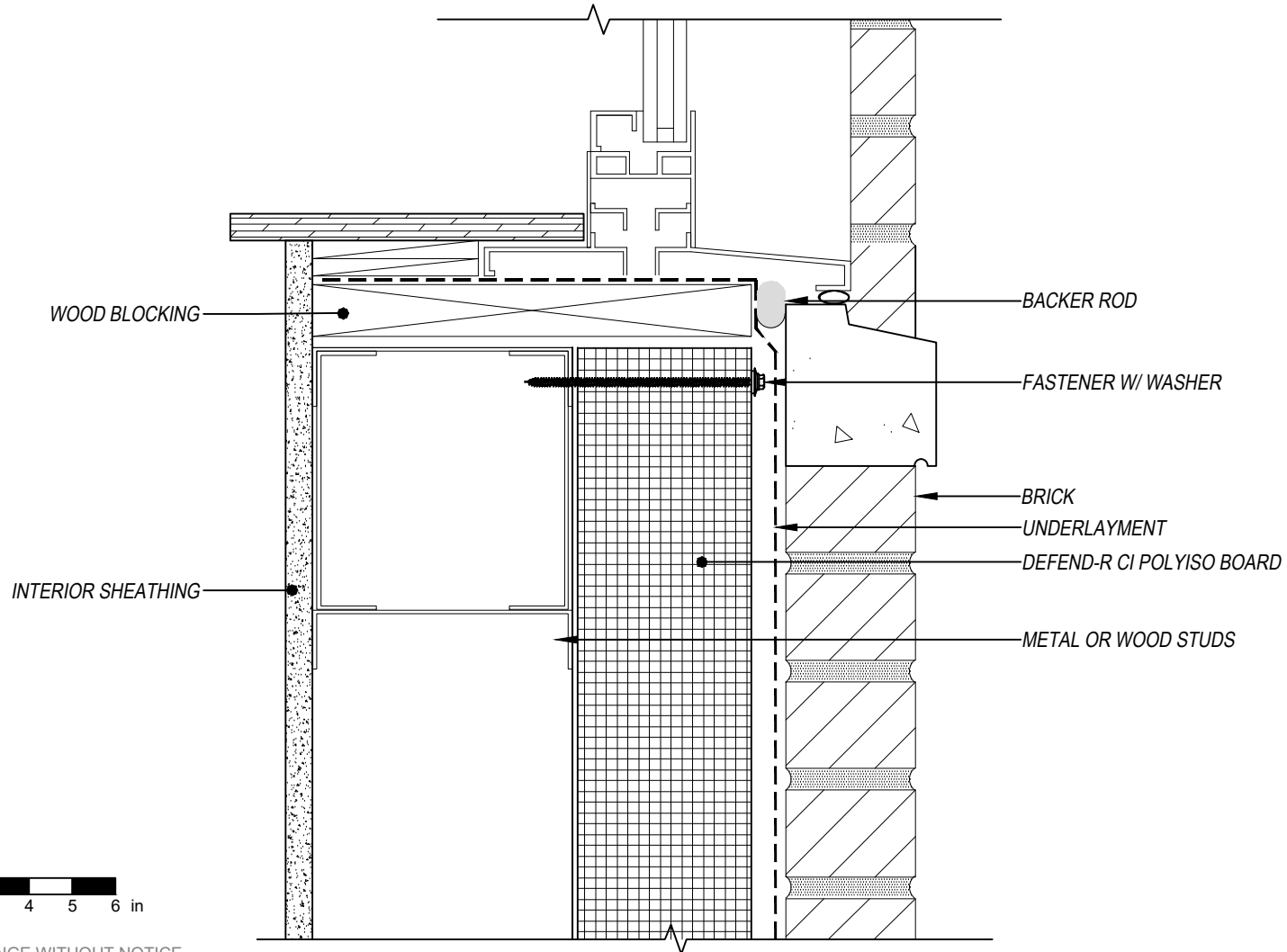

SCALE: 3" = 1'-0"

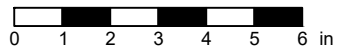

SUBJECT TO CHANGE WITHOUT NOTICE

DISCLAIMER: DETAIL SHOWN FOR ILLUSTRATION PURPOSES ONLY. ACTUAL PROJECT DETAIL MAY VARY