

# DMC 200S - SOLID SUBSTRATE

- DMC 200S PANEL
- DREXEL APPROVED SEALANT (OPTIONAL)  
(FIELD OR MACHINE APPLIED SEALANT)
- DMC 200S BUTTERFLY CLIP
- (2) #10 - 13 x 1" PHW
- METSHIELD UNDERLAYMENT
- 1/2" PLYWOOD MIN.

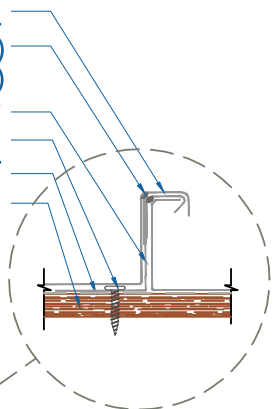

CROSS SECTION  
BEFORE SEAMING

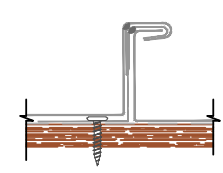

CROSS SECTION  
90° SEAMING

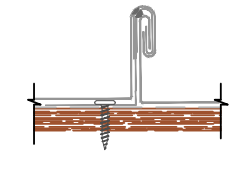

CROSS SECTION  
180° SEAMING

ZOOMED IN VIEW

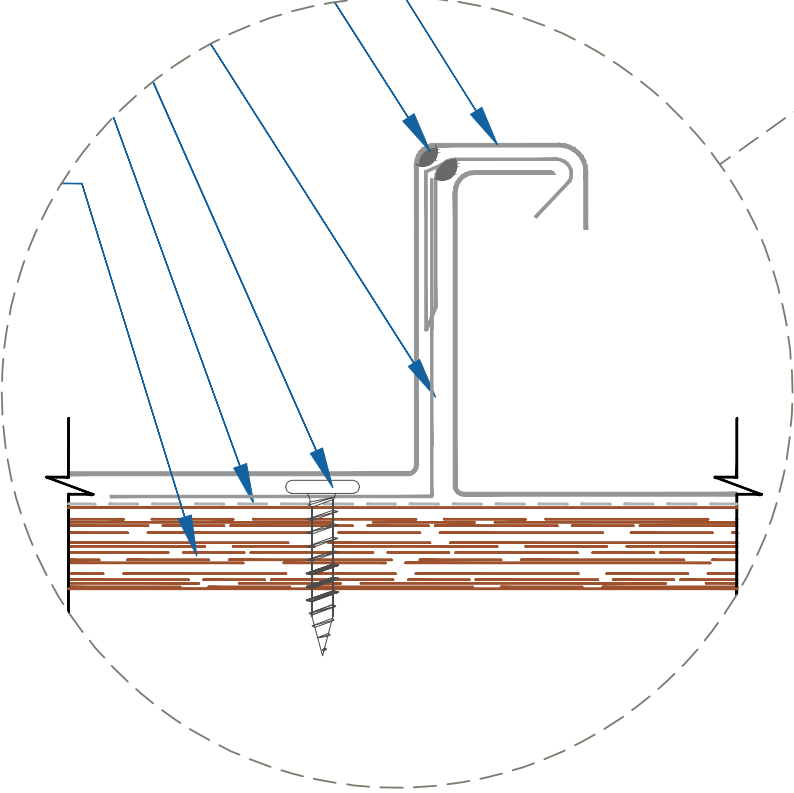

NTS

SEAMER TOOL RENTAL  
SEAMER TOOLS, INC.  
8265 HIGHWAY 178  
OLIVE BRANCH, MS 38654  
PH:(662)895-1222  
FAX:(662)890-4775  
RENT@SEAMERTOOLS.COM

EFFECTIVE DATE: 12-07-12  
SUBJECT TO CHANGE WITHOUT NOTICE

## INSTALLATION DETAIL

SCALE: 3" = 1'-0"



# DMC 200S - PLYWOOD

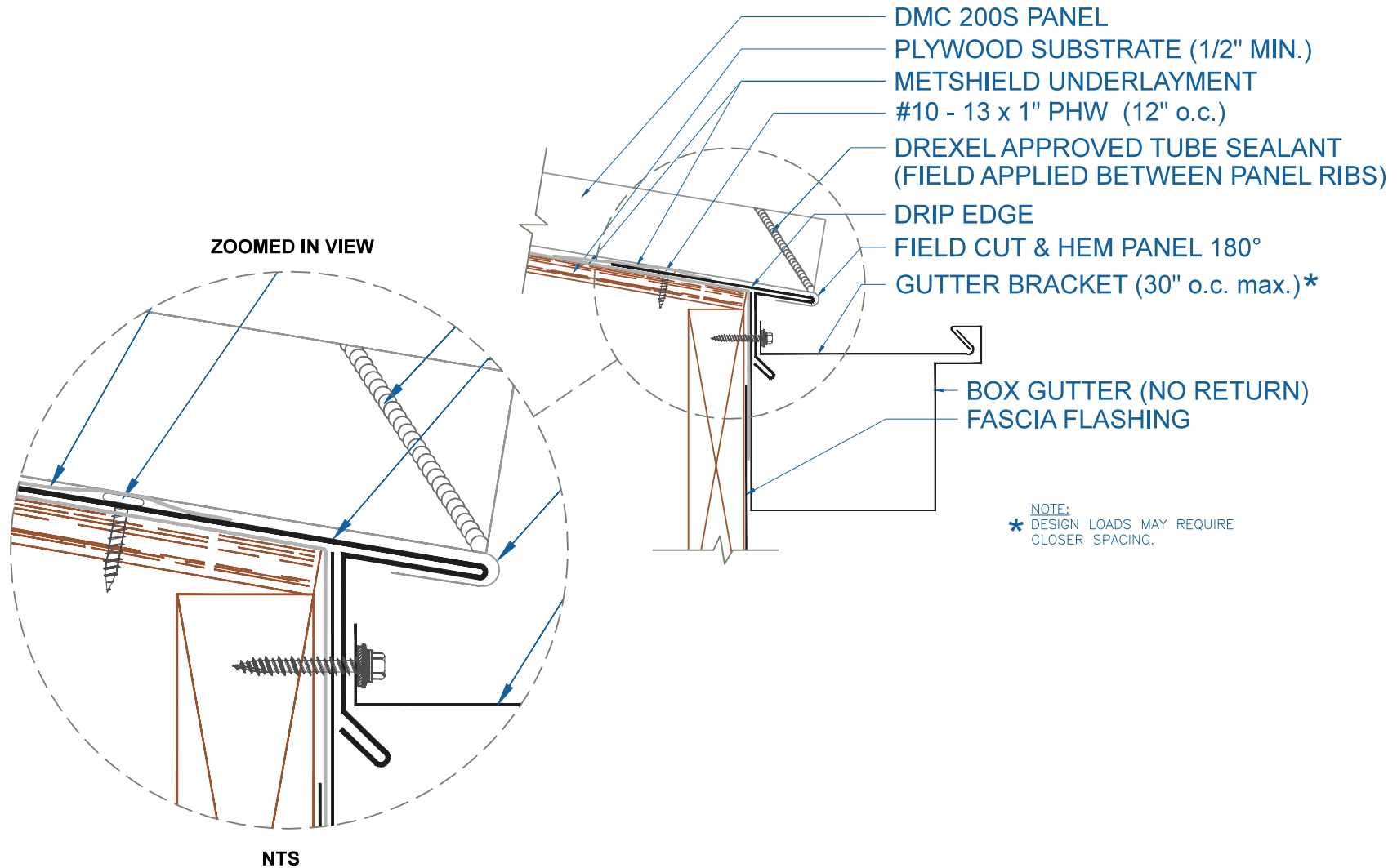

## BOX GUTTER w/DRIP EDGE

SCALE: 3" = 1'-0"

EFFECTIVE DATE: 01-04-13  
SUBJECT TO CHANGE WITHOUT NOTICE



# DMC 200S - PLYWOOD

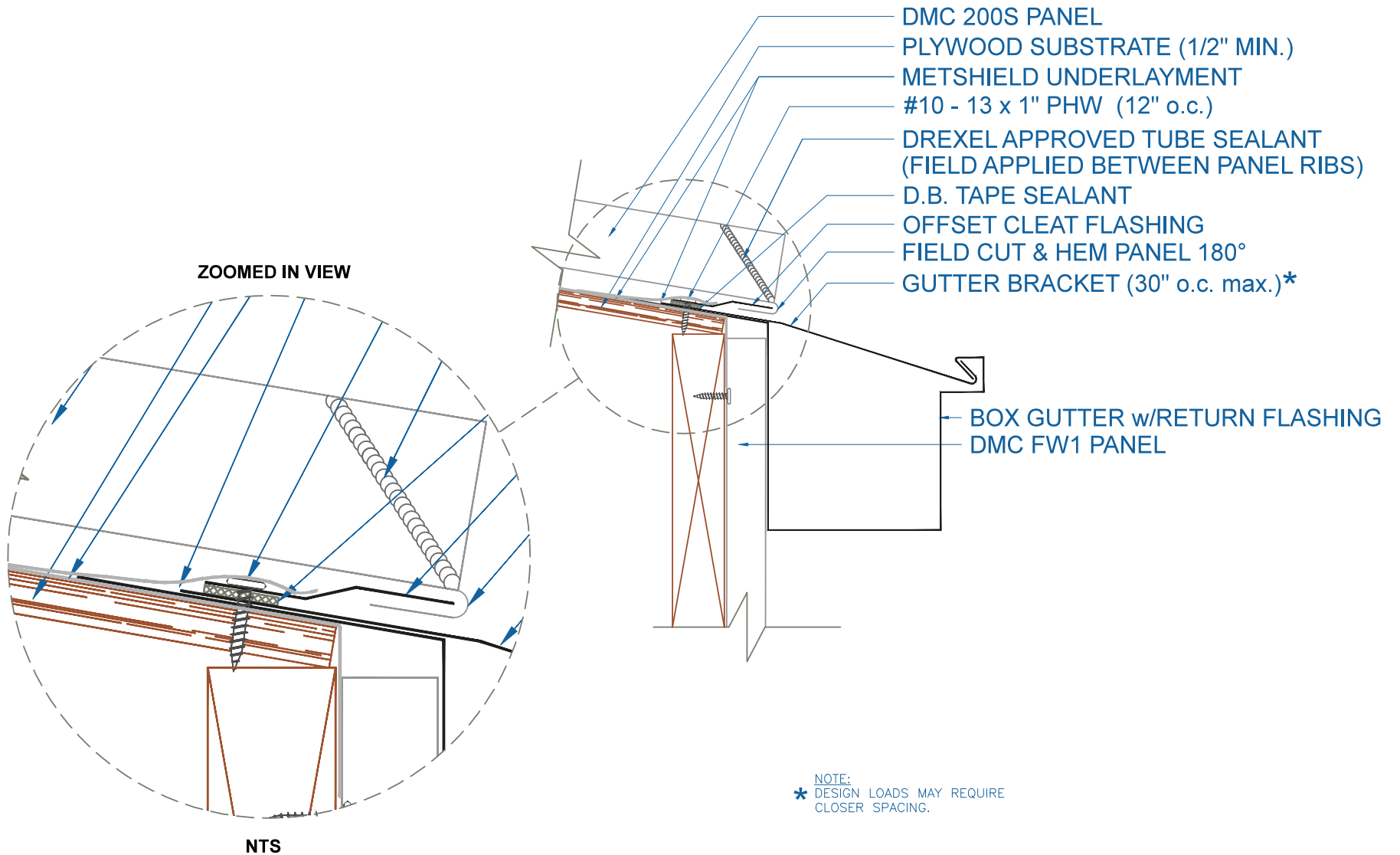

## BOX GUTTER w/RETURN

SCALE: 3" = 1'-0"

EFFECTIVE DATE: 4-18-13  
SUBJECT TO CHANGE WITHOUT NOTICE

# DMC 200S - PLYWOOD

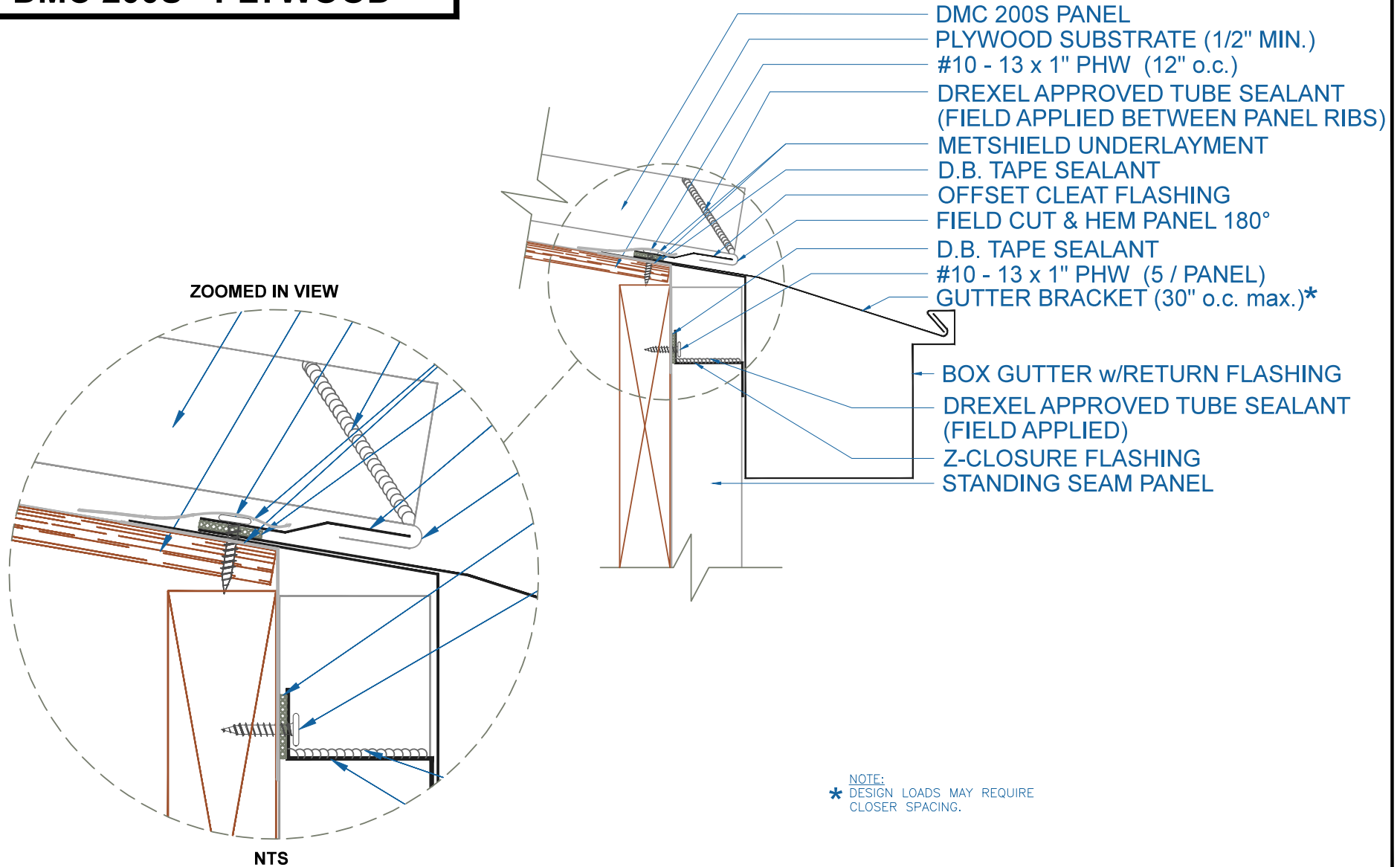

## BOX GUTTER w/RETURN w/STANDING SEAM PANEL

SCALE: 3" = 1'-0"

EFFECTIVE DATE: 12-07-12  
SUBJECT TO CHANGE WITHOUT NOTICE

# DMC 200S - PLYWOOD

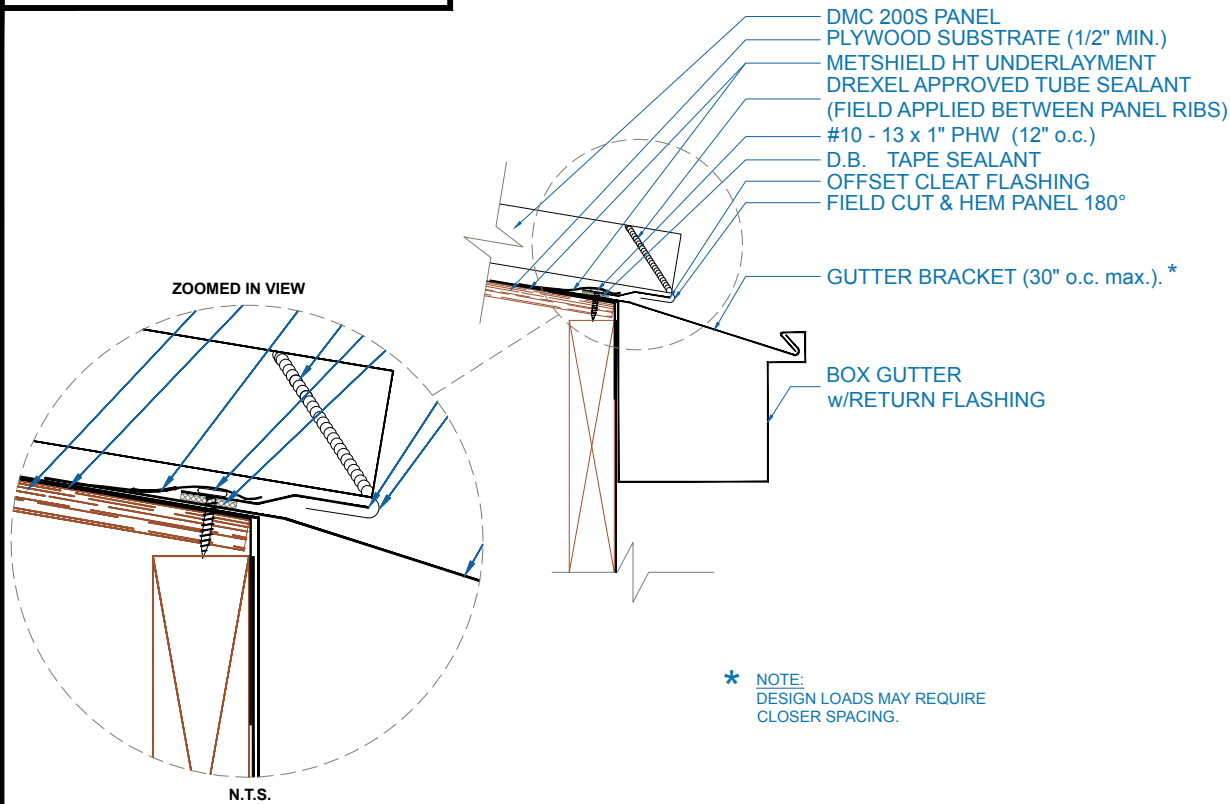

## BOX GUTTER w/RETURN

SCALE: 3" = 1'-0"

EFFECTIVE DATE: 12-07-12  
SUBJECT TO CHANGE WITHOUT NOTICE

# DMC 200S - PLYWOOD

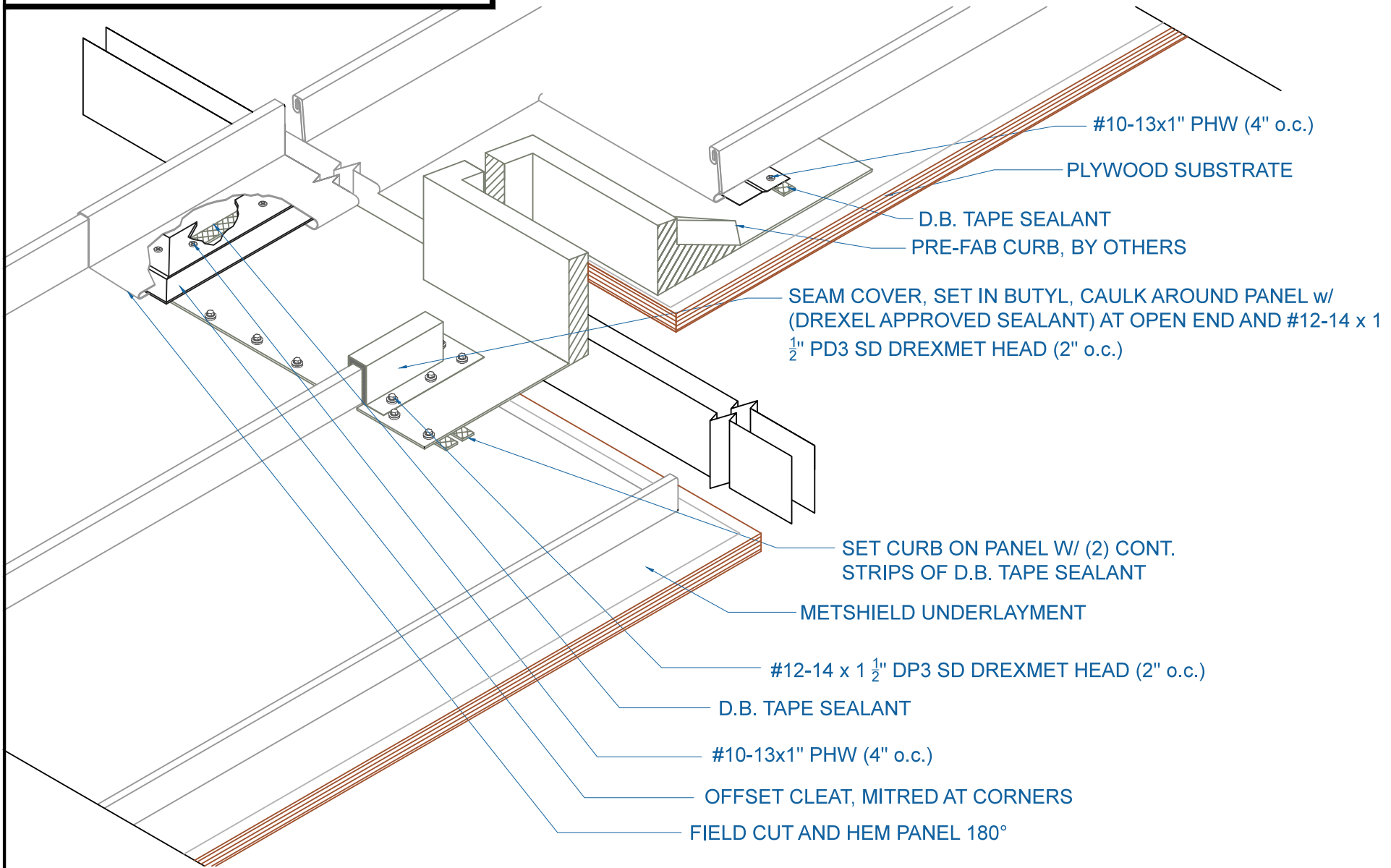

EFFECTIVE DATE: 01-18-2013  
SUBJECT TO CHANGE WITHOUT NOTICE

## CURB DETAIL

SCALE: NTS

# DMC 200S - PLYWOOD

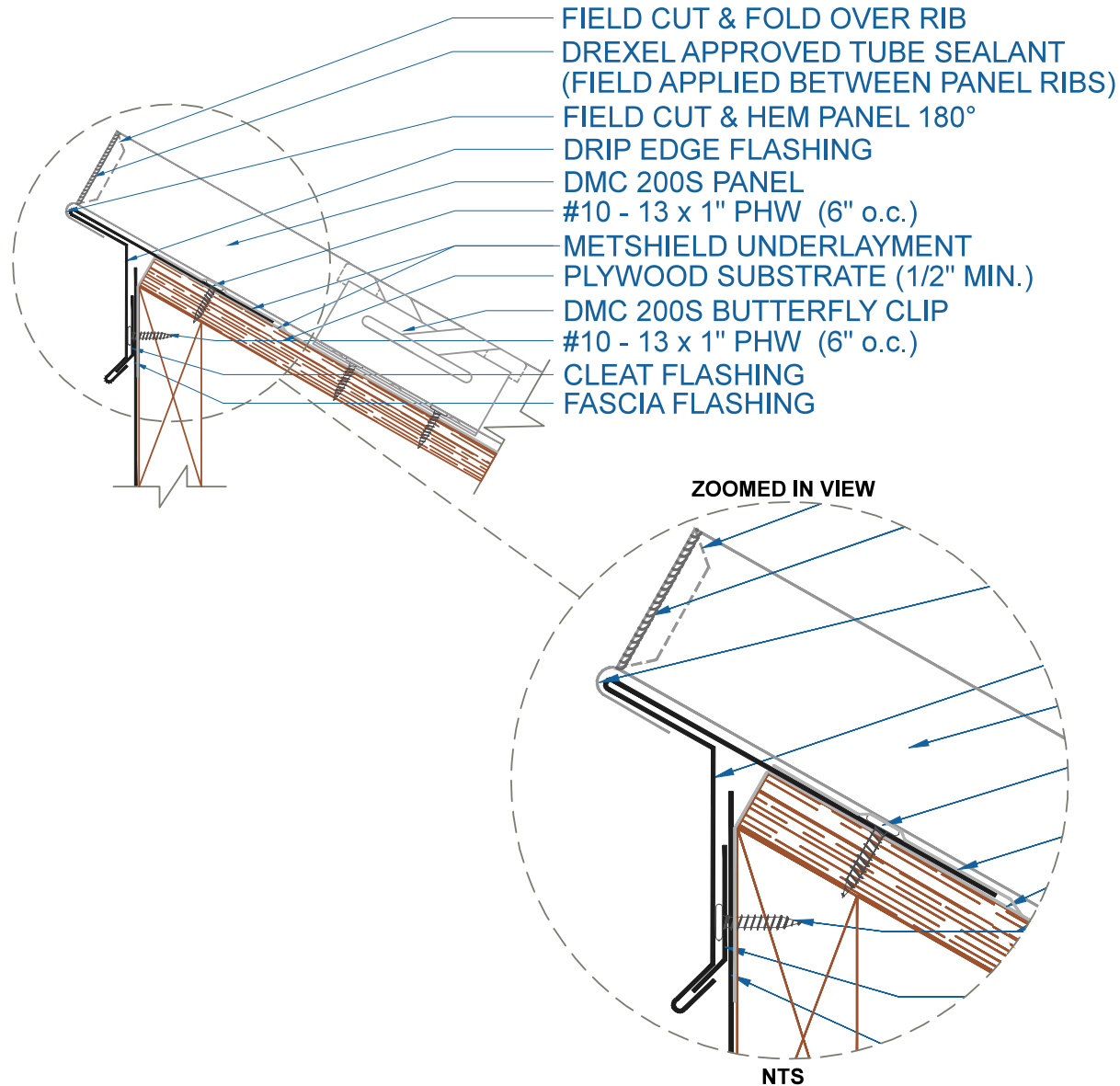

EFFECTIVE DATE: 12-07-12  
SUBJECT TO CHANGE WITHOUT NOTICE

## PEAK w/DRIP EDGE

SCALE: 3" = 1'-0"

**DrexelMetals**  
Roofing Systems + Custom Fabrication



# DMC 200S - PLYWOOD

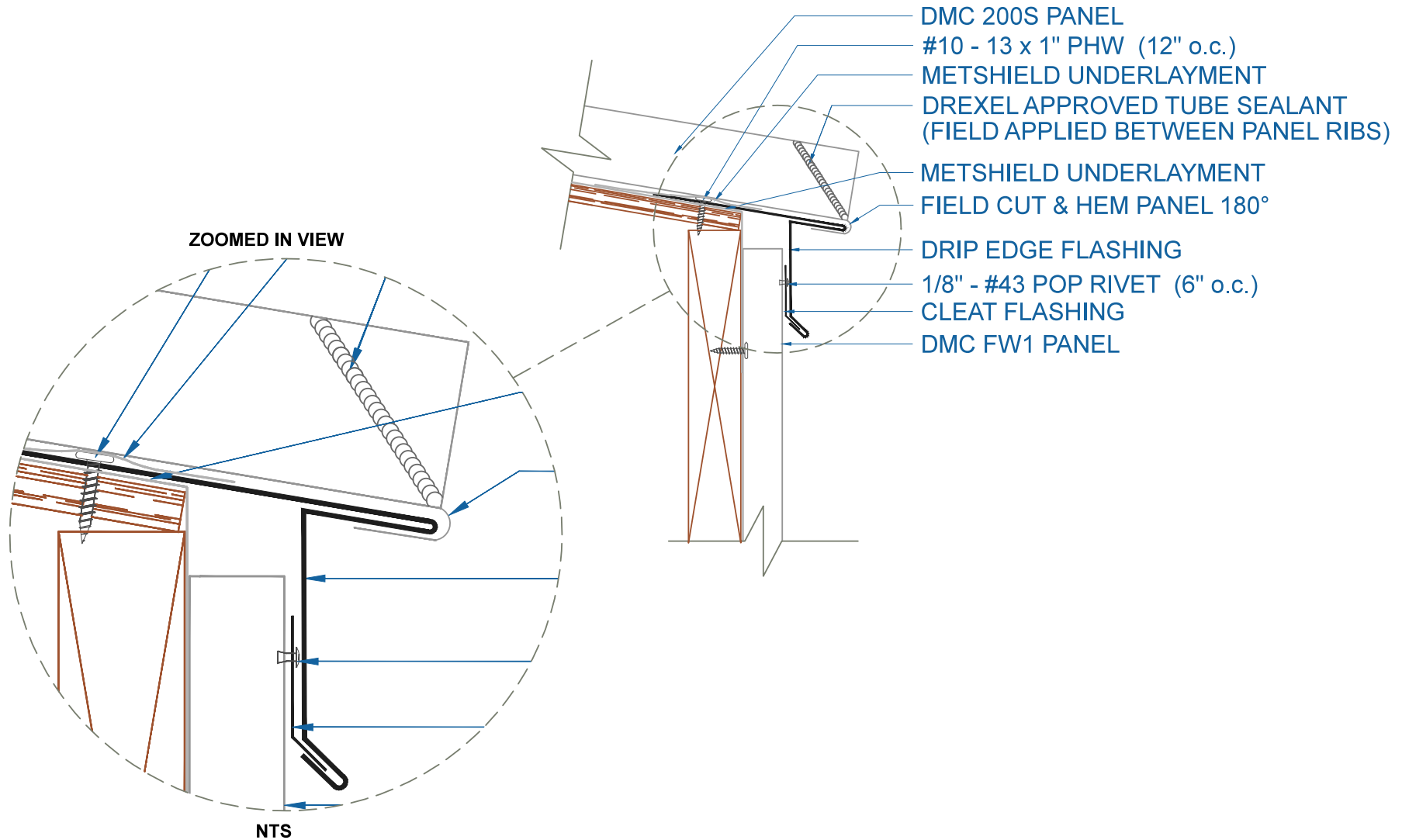

## DRIP EDGE w/FLUSH PANEL

SCALE: 3" = 1'-0"

EFFECTIVE DATE: 12-11-12  
SUBJECT TO CHANGE WITHOUT NOTICE



# DMC 200S - PLYWOOD

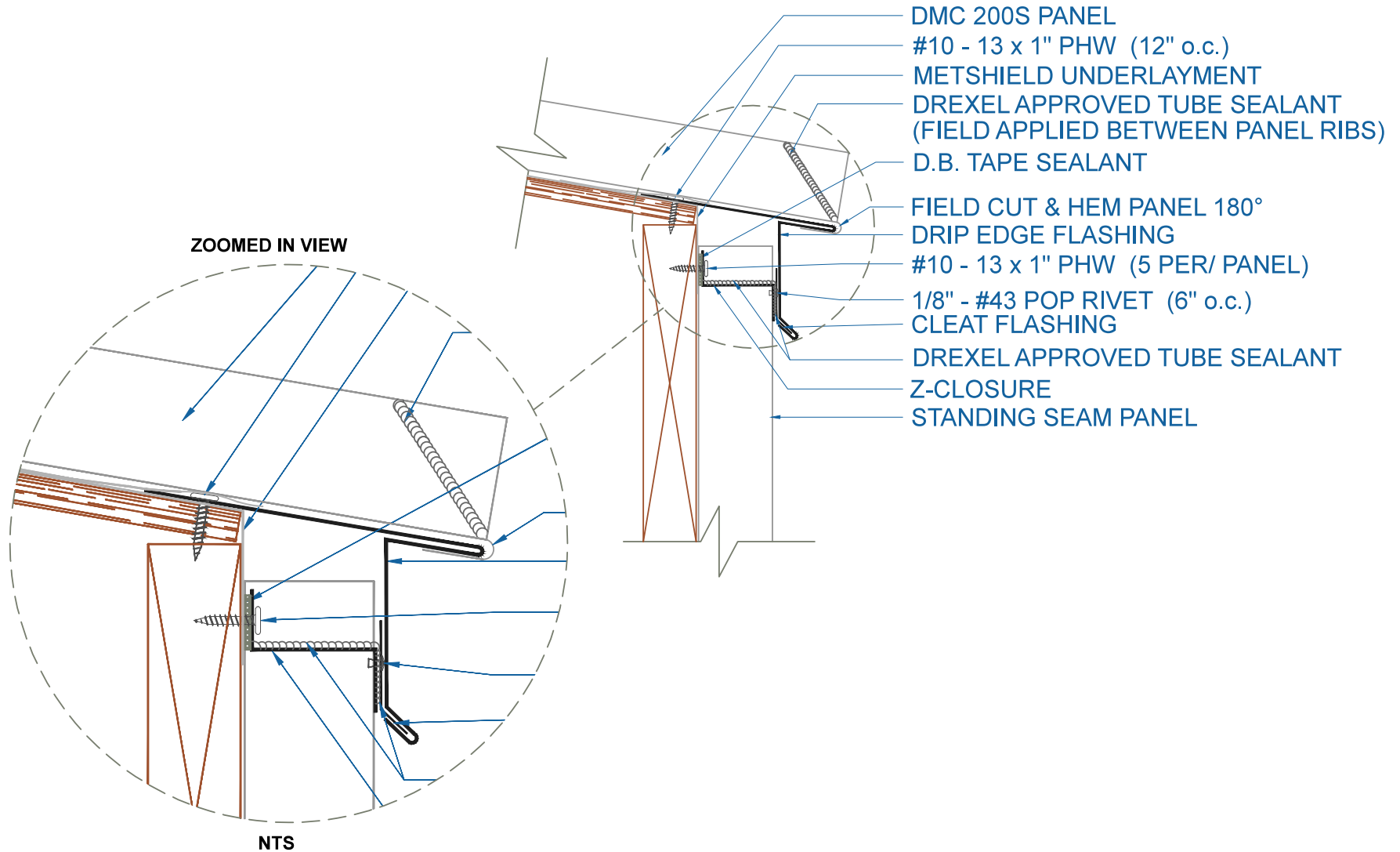

## DRIP EDGE w/STANDING SEAM PANEL

EFFECTIVE DATE: 12-07-12  
SUBJECT TO CHANGE WITHOUT NOTICE

SCALE: 3" = 1'-0"



# DMC 200S - PLYWOOD

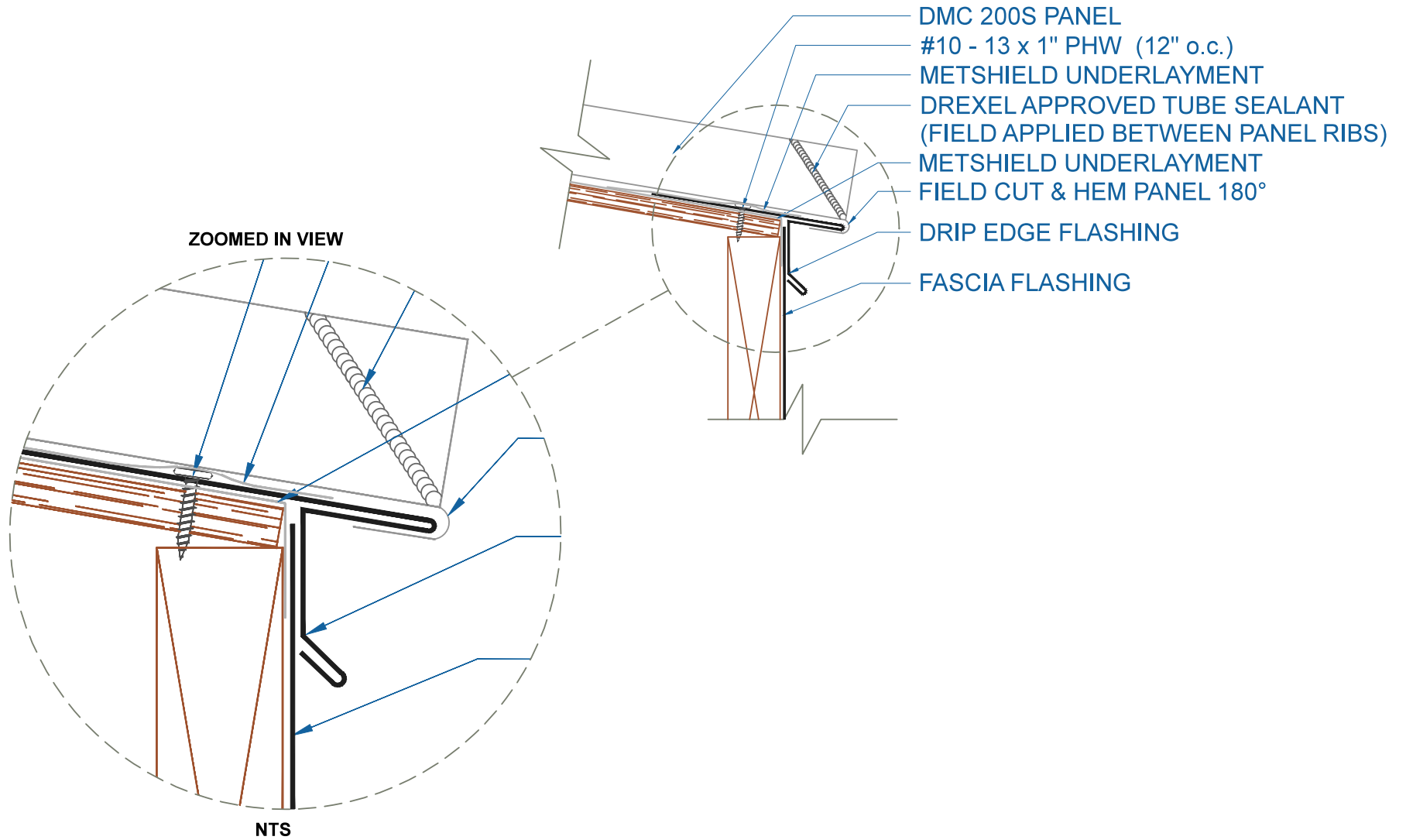

EFFECTIVE DATE: 01-04-13  
SUBJECT TO CHANGE WITHOUT NOTICE

## DRIP EDGE

SCALE: 3" = 1'-0"

# DMC 200S - PLYWOOD

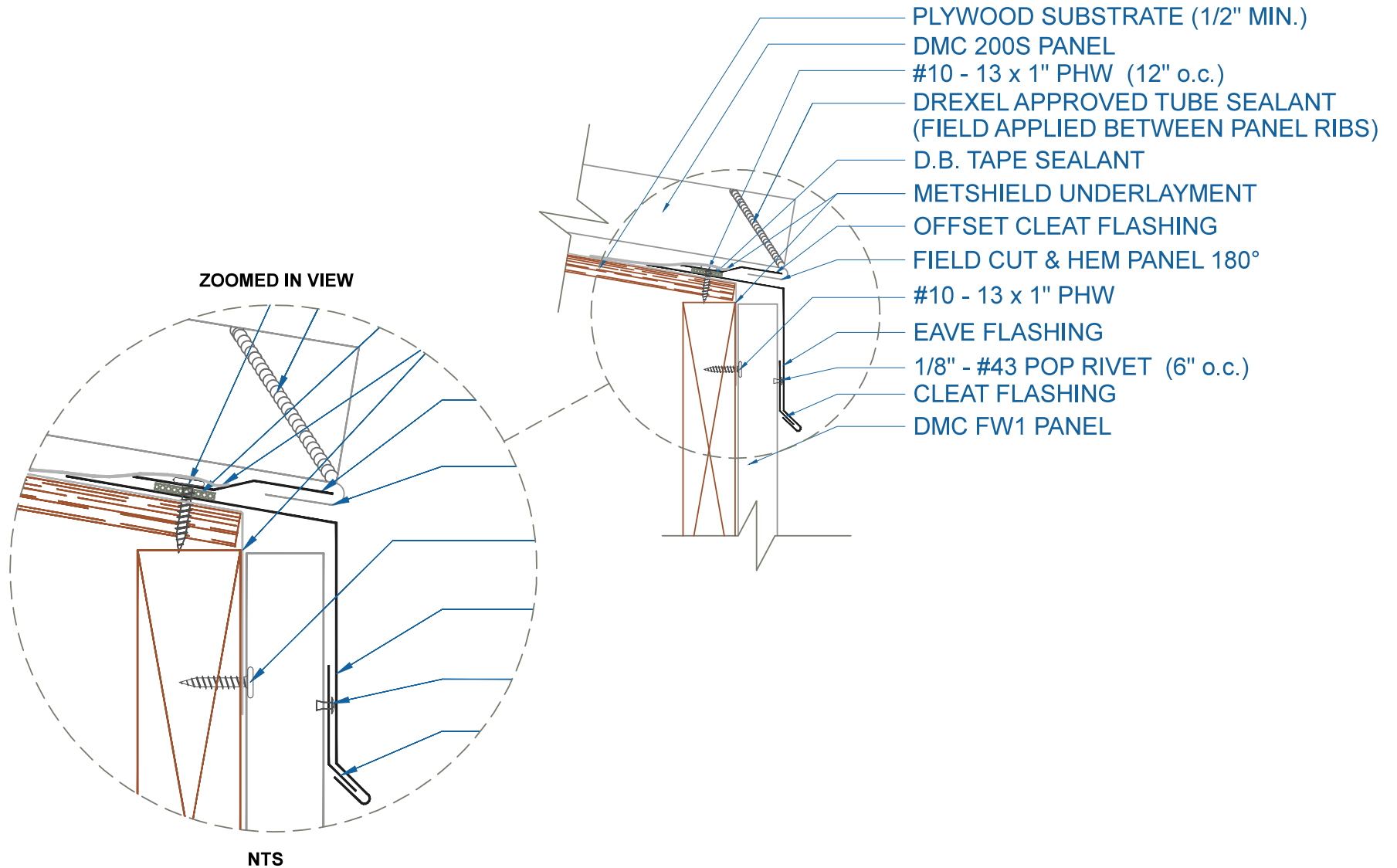

EFFECTIVE DATE: 12-07-12  
 SUBJECT TO CHANGE WITHOUT NOTICE

## EAVE w/FLUSH PANEL

SCALE: 3" = 1'-0"

# DMC 200S - PLYWOOD

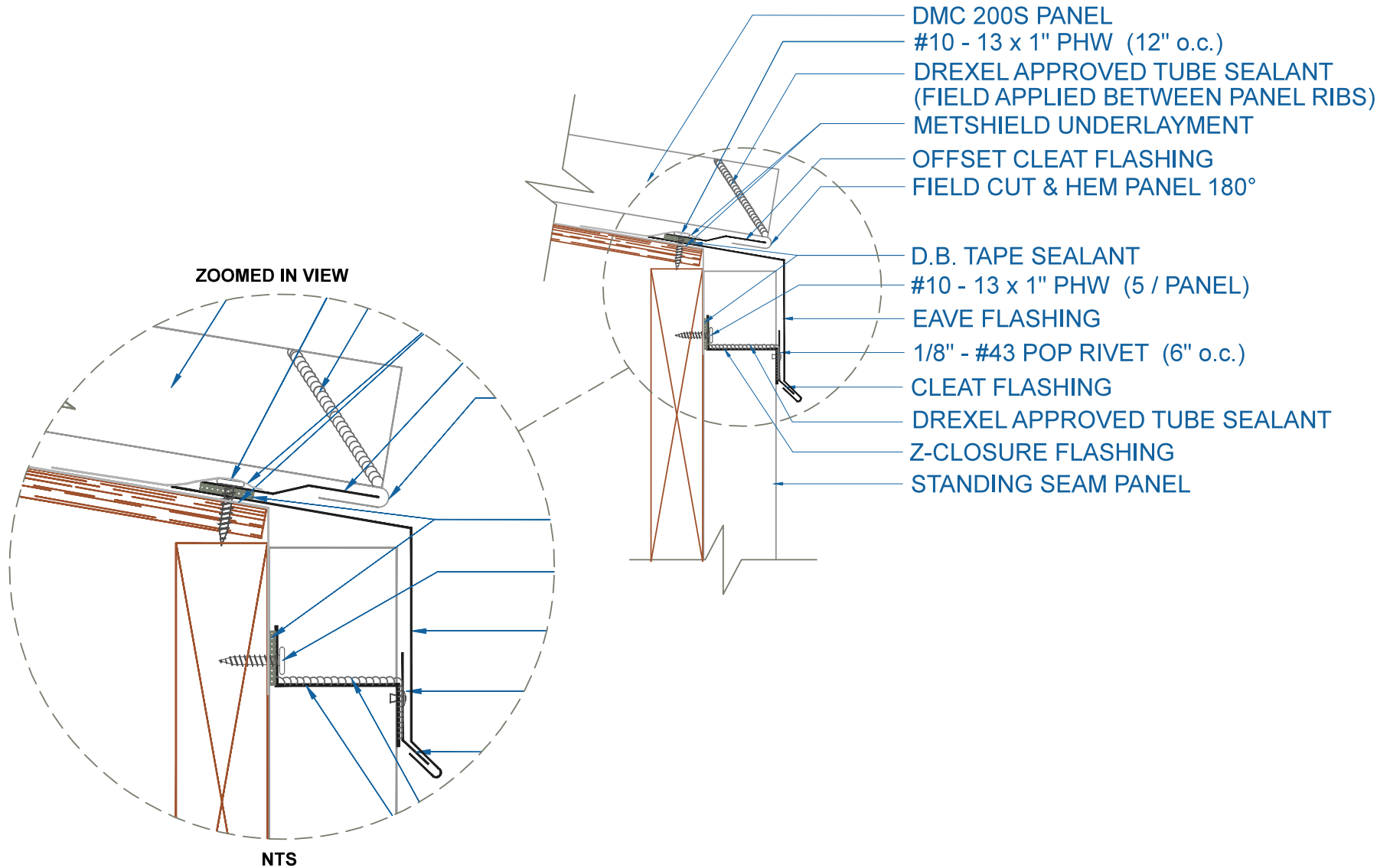

## EAVE w/STANDING SEAM PANEL

SCALE: 3" = 1'-0"

EFFECTIVE DATE: 12-07-12  
SUBJECT TO CHANGE WITHOUT NOTICE

# DMC 200S - OPEN FRAMING

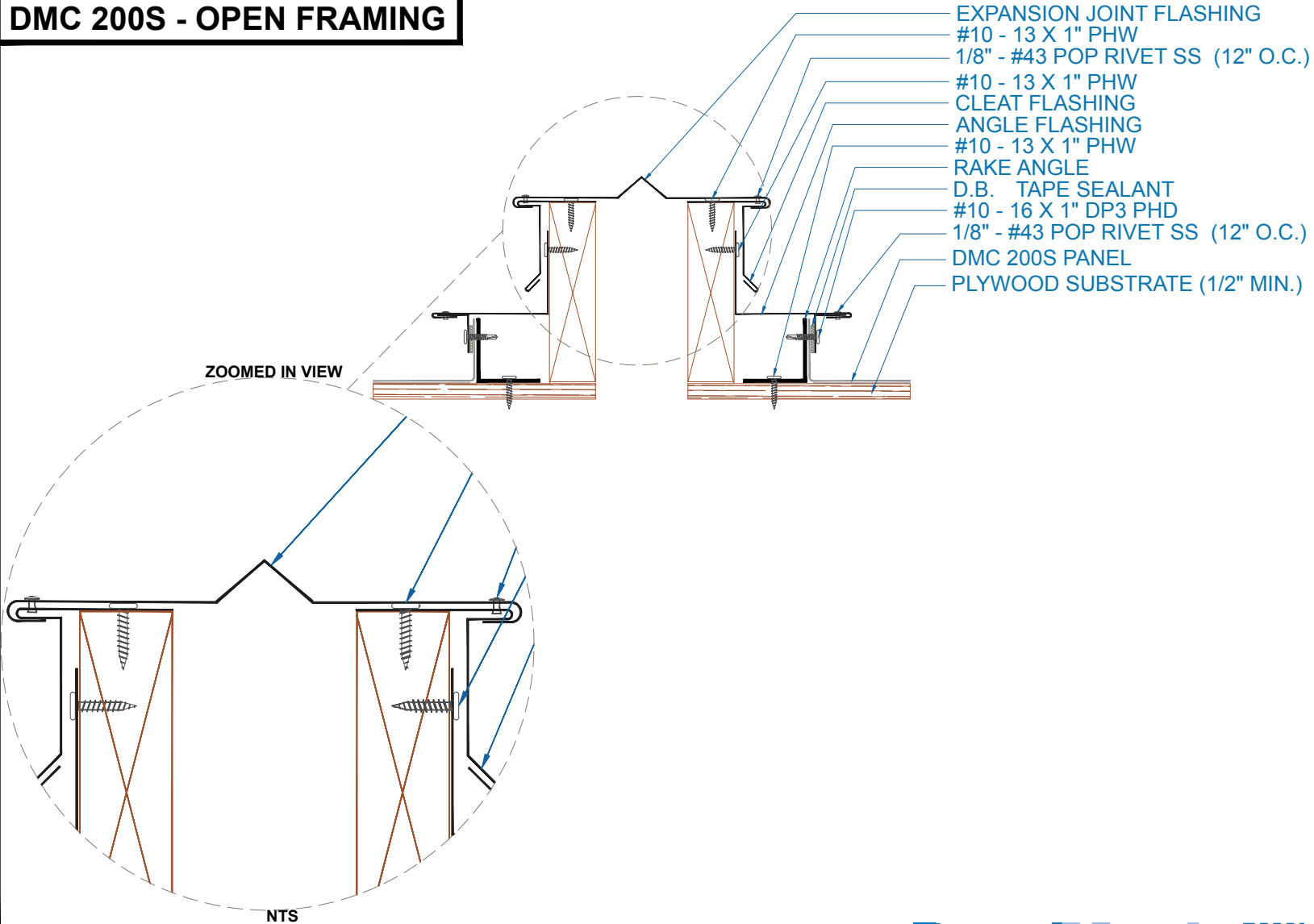

EFFECTIVE DATE: 11-9-16  
 SUBJECT TO CHANGE WITHOUT NOTICE

## EXPANSION JOINT

SCALE: 3" = 1'-0"

# DMC 200S - PLYWOOD

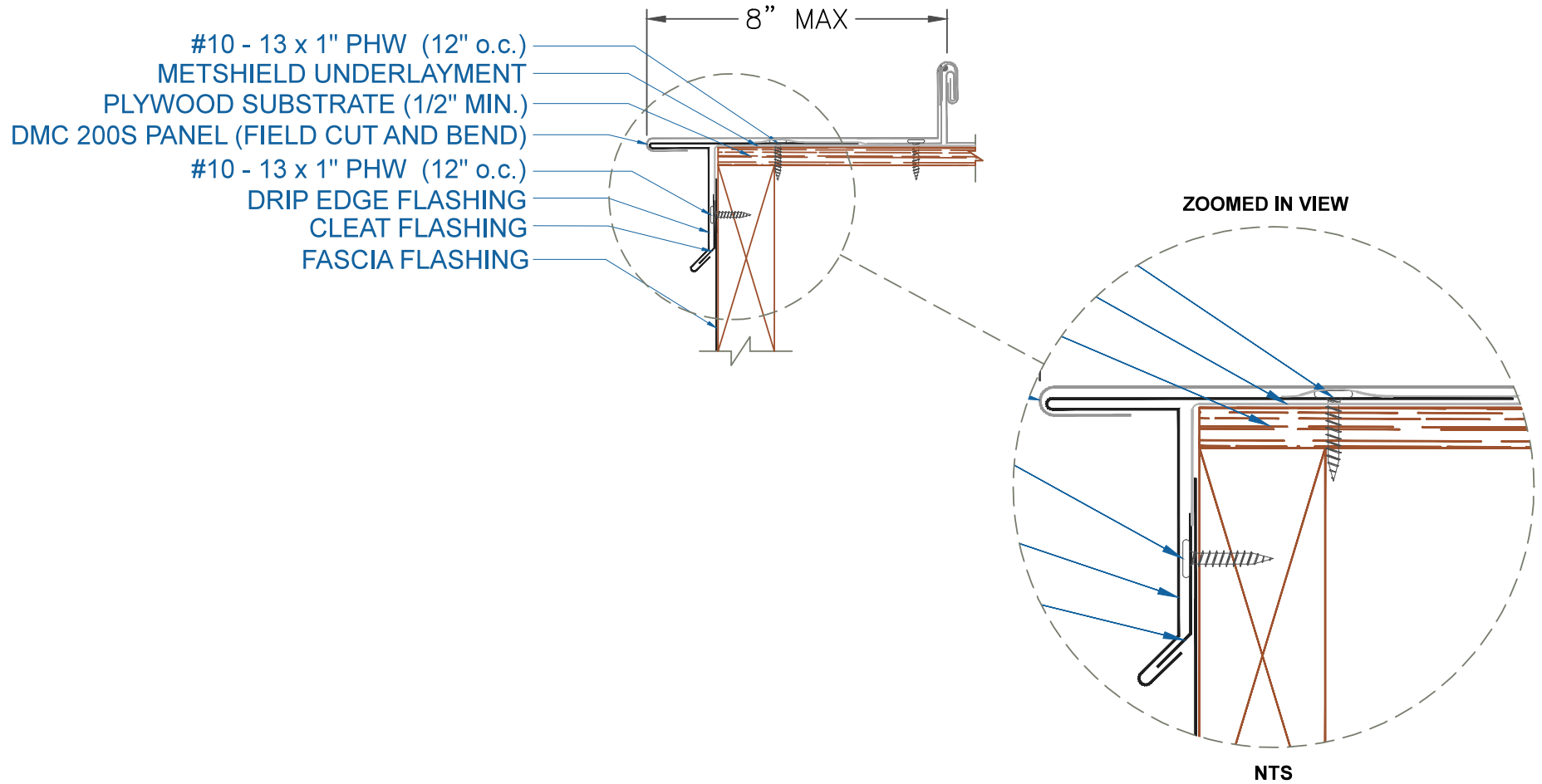

## GABLE w/DRIP EDGE

SCALE: 3" = 1'-0"

EFFECTIVE DATE: 12-11-12  
SUBJECT TO CHANGE WITHOUT NOTICE



# DMC 200S - PLYWOOD

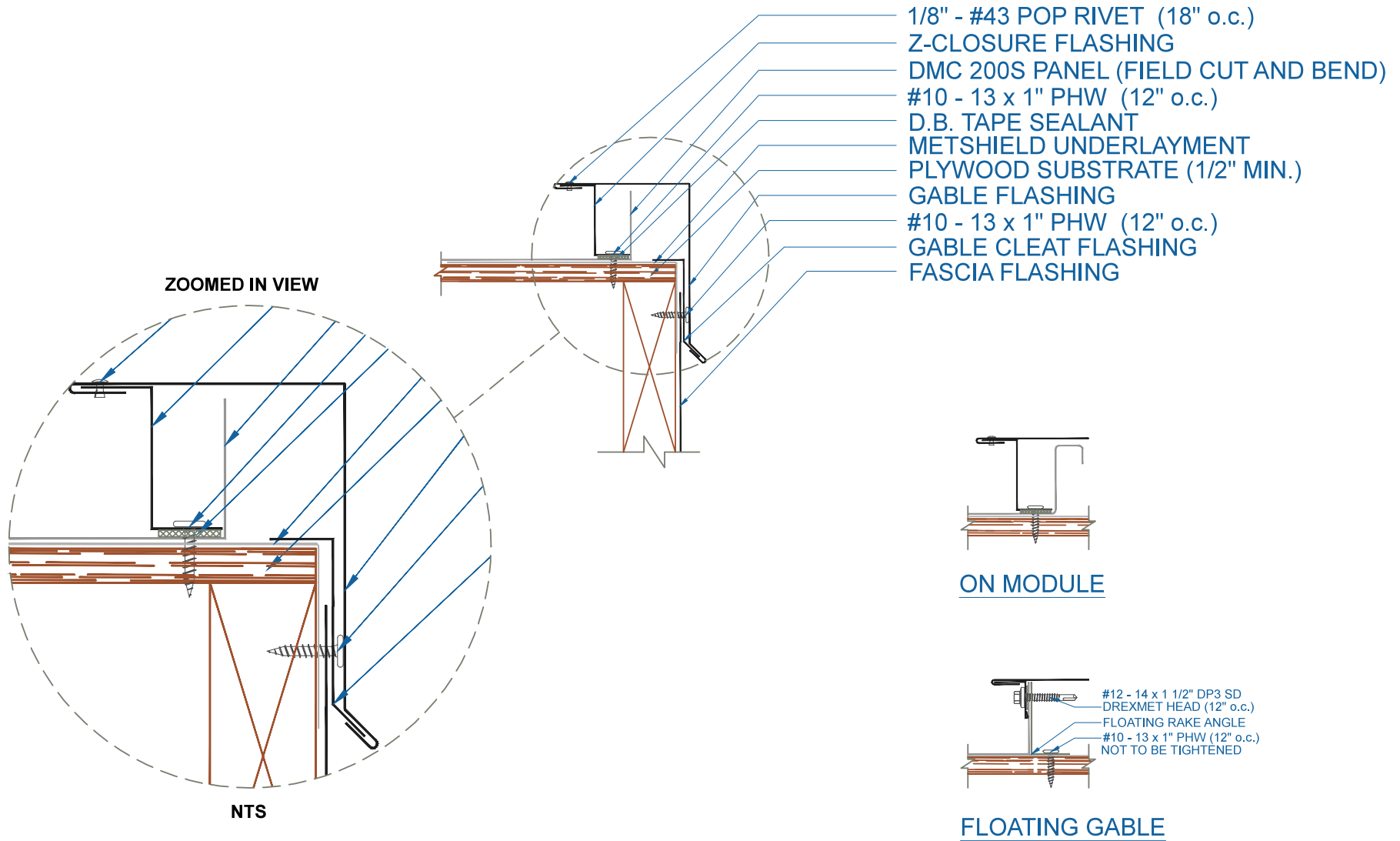

EFFECTIVE DATE: 12-11-12  
 SUBJECT TO CHANGE WITHOUT NOTICE

**GABLE**  
 SCALE: 3" = 1'-0"

# DMC 200S - PLYWOOD

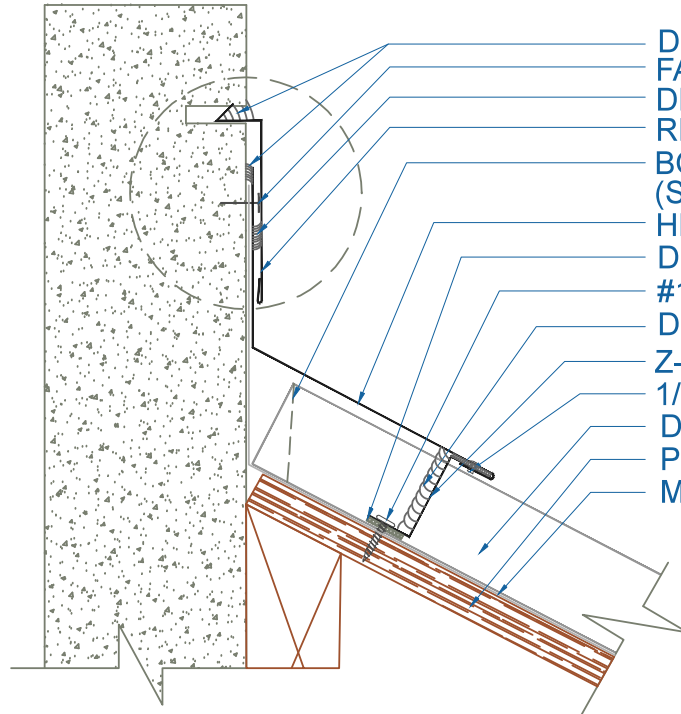

- DREXEL APPROVED TUBE SEALANT
- FASTENERS (BY OTHERS)
- DREXEL APPROVED TUBE SEALANT
- REGLET FLASHING
- BOX END OF PANEL  
(SEE ZEE CLOSURE OPTIONS DETAIL)
- HEADWALL FLASHING
- D.B. TAPE SEALANT
- #10 - 13 x 1" PHW (5 PER PANEL)
- DREXEL APPROVED TUBE SEALANT
- Z-CLOSURE FLASHING
- 1/8" - #43 POP RIVET (18" o.c.)
- DMC 200S PANEL
- PLYWOOD SUBSTRATE (1/2" MIN.)
- METSHIELD UNDERLAYMENT

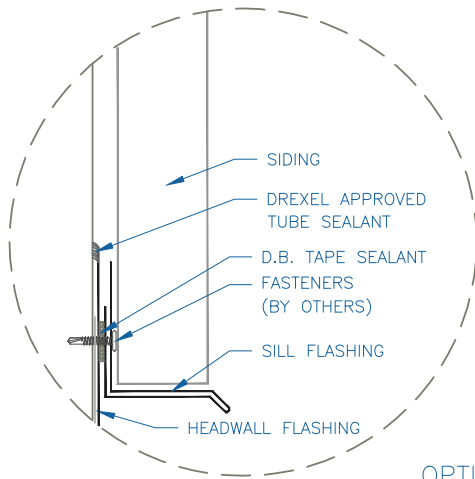

OPTION 1

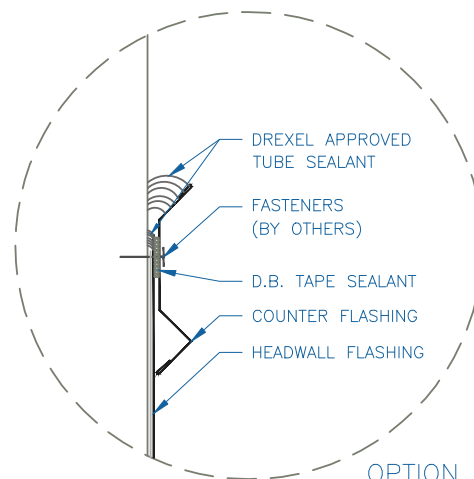

OPTION 2

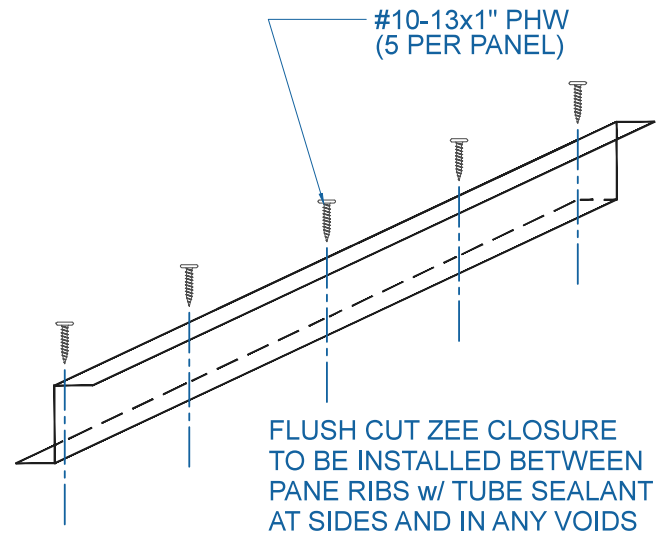

FLUSH CUT ZEE CLOSURE  
TO BE INSTALLED BETWEEN  
PANE RIBS w/ TUBE SEALANT  
AT SIDES AND IN ANY VOIDS

EFFECTIVE DATE: 12-11-12  
SUBJECT TO CHANGE WITHOUT NOTICE

## HEADWALL

SCALE: 3" = 1'-0"



# DMC 200S - PLYWOOD

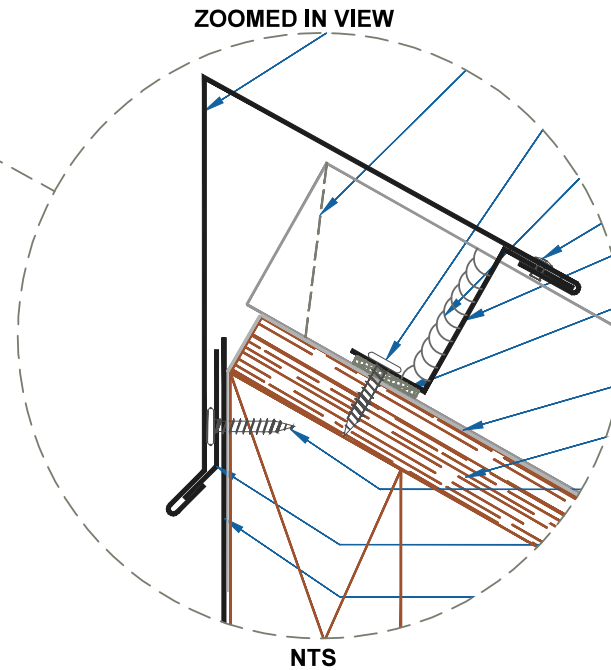
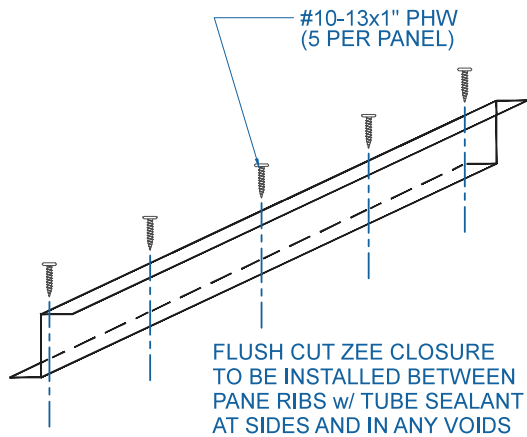
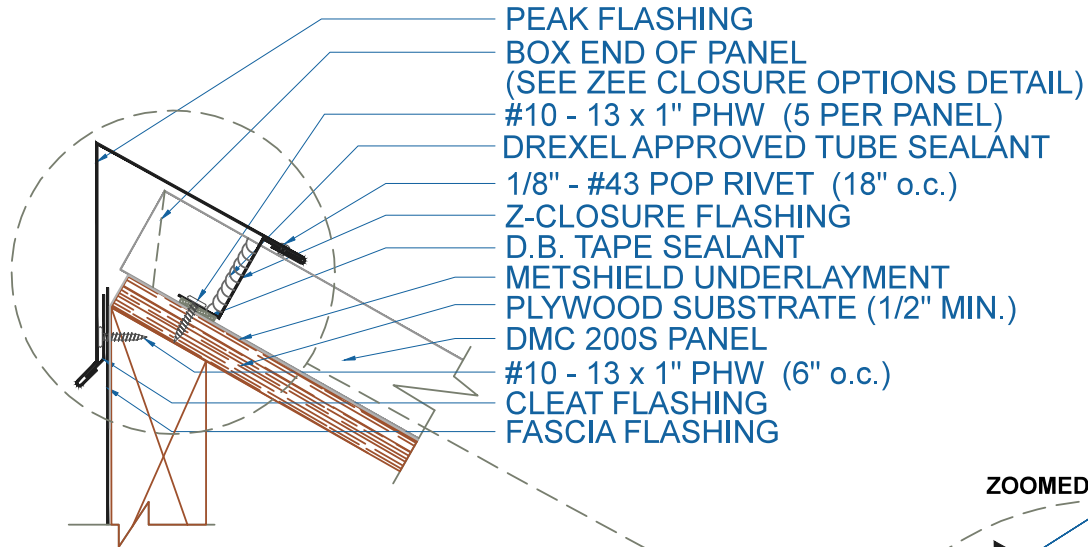

EFFECTIVE DATE: 12-11-12  
SUBJECT TO CHANGE WITHOUT NOTICE

**PEAK**  
SCALE: 3" = 1'-0"

**DrexelMetals**  
Roofing Systems + Custom Fabrication



# DMC 200S - PLYWOOD

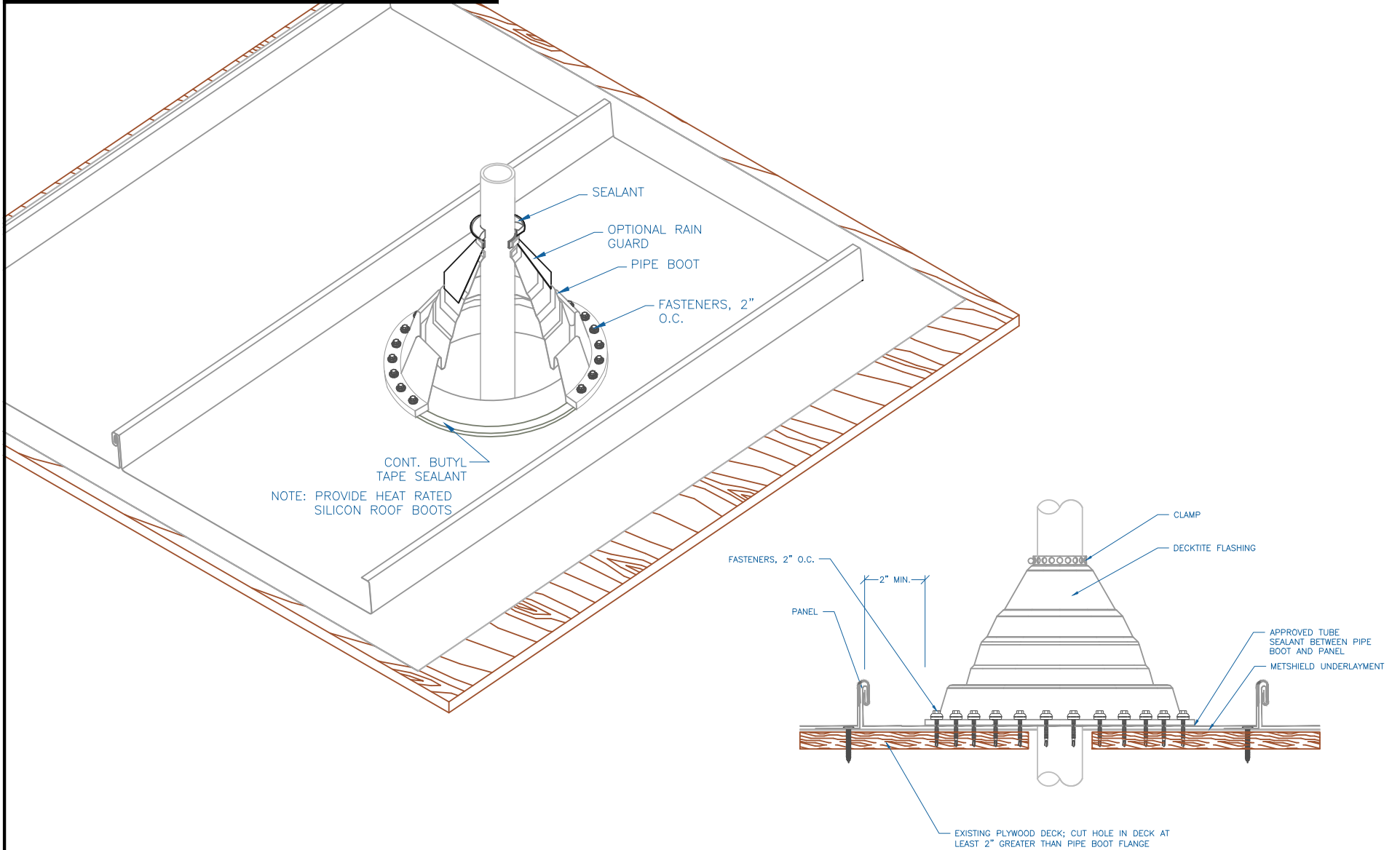

EFFECTIVE DATE: 11-09-12  
SUBJECT TO CHANGE WITHOUT NOTICE

## PIPE FLASHING DETAIL

SCALE: NTS



# DMC 200S - PLYWOOD

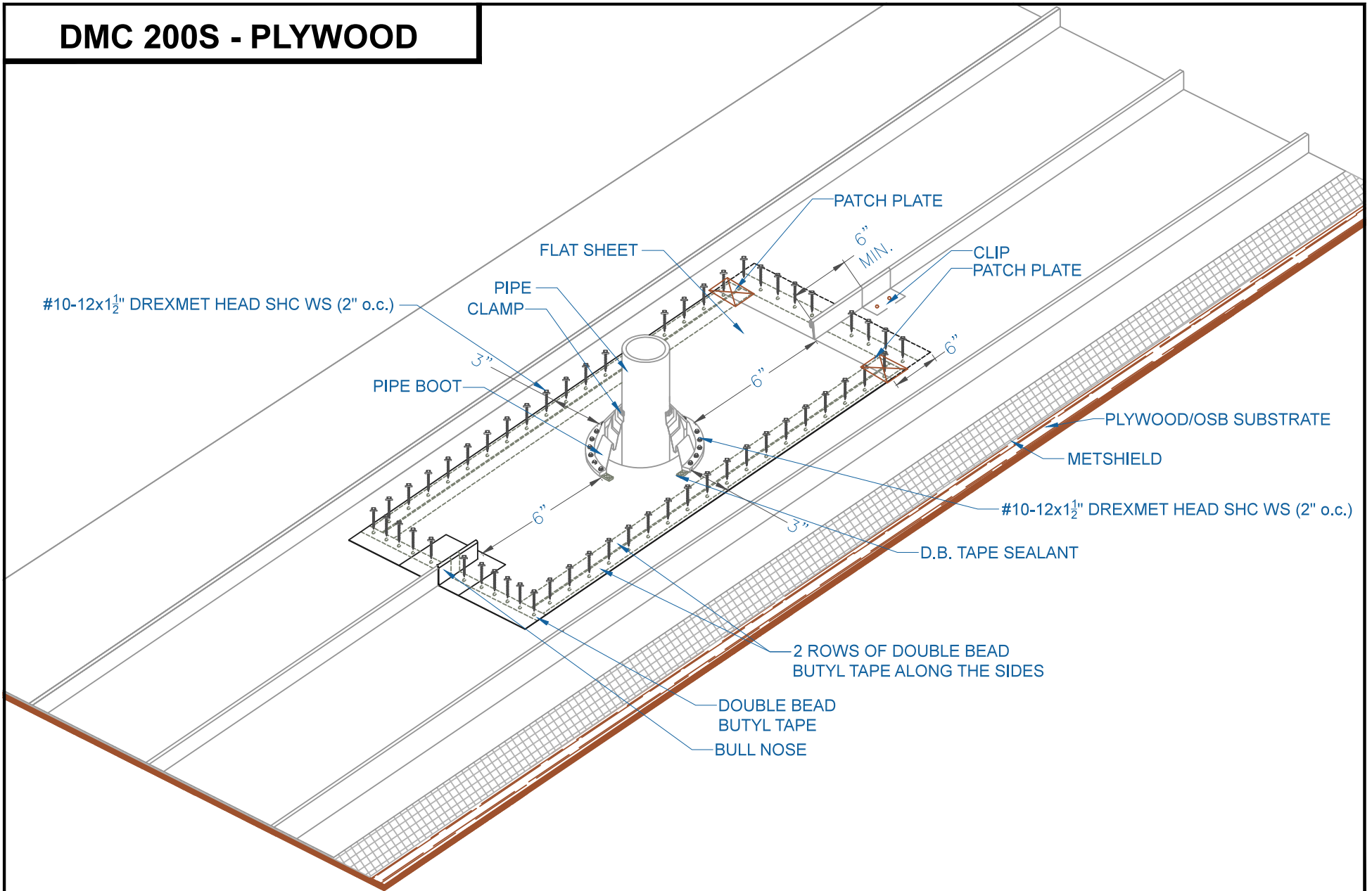

## PIPE FLASHING PAN DETAIL

SCALE: NTS

EFFECTIVE DATE: 12-13-12  
SUBJECT TO CHANGE WITHOUT NOTICE



# DMC 200S - PLYWOOD

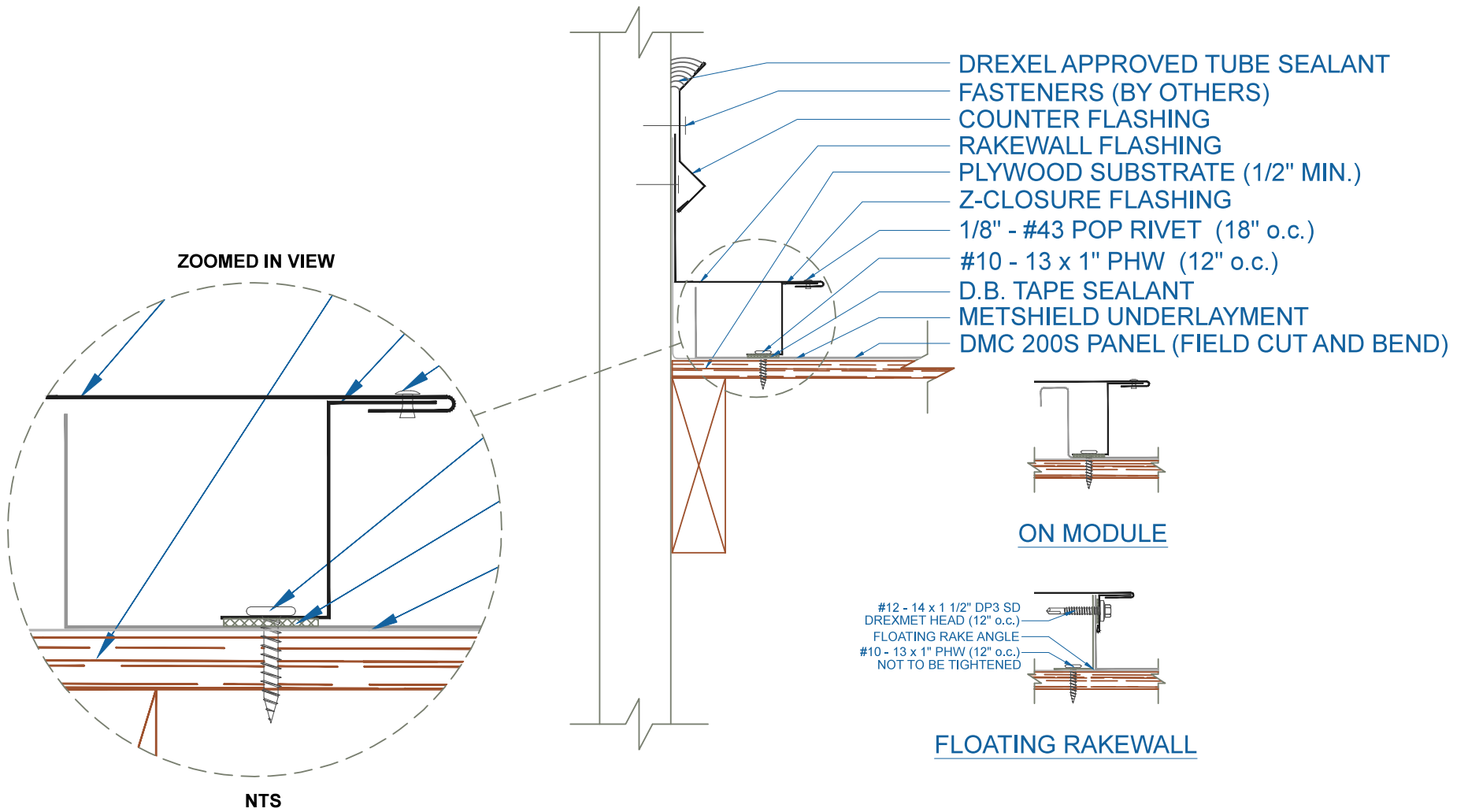

EFFECTIVE DATE: 12-07-12  
SUBJECT TO CHANGE WITHOUT NOTICE

## RAKEWALL

SCALE: 3" = 1'-0"

# DMC 200S - PLYWOOD

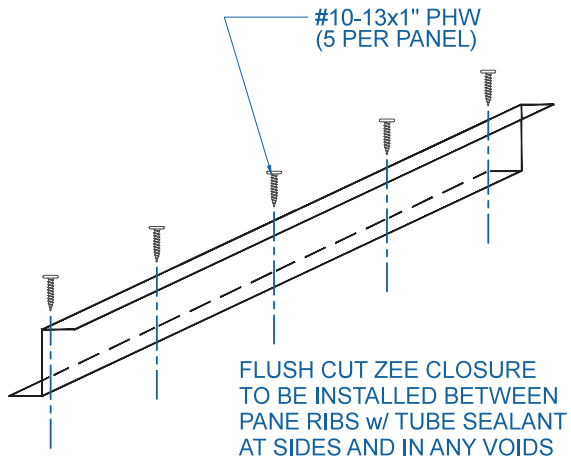
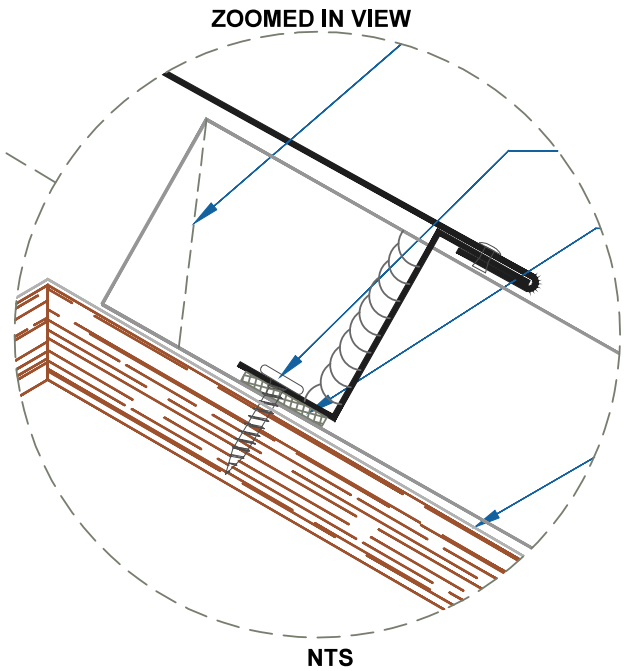
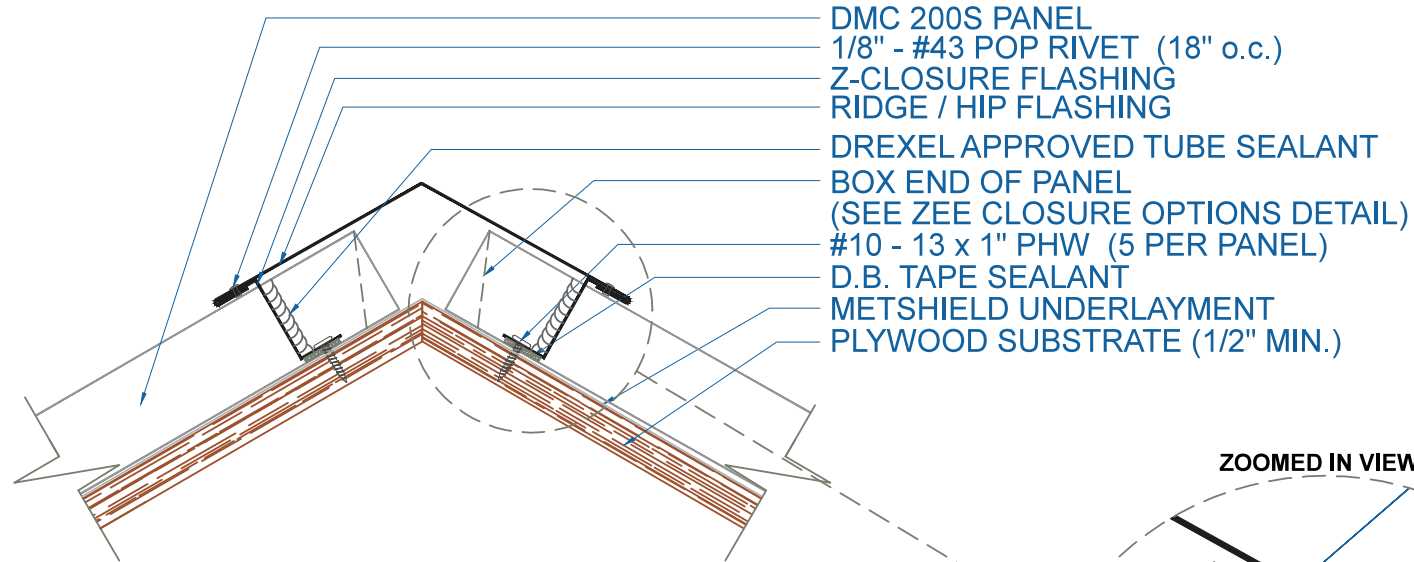

EFFECTIVE DATE: 12-11-12  
 SUBJECT TO CHANGE WITHOUT NOTICE

## RIDGE / HIP

SCALE: 3" = 1'-0"

# DMC 200S - PLYWOOD

- DMC 200S PANEL
- #10 - 13 x 1" PHW (12" o.c.)
- D.B. TAPE SEALANT
- OFFSET CLEAT FLASHING
- FIELD CUT & HEM PANEL 180°
- BOX END OF PANEL  
(SEE ZEE CLOSURE OPTIONS DETAIL)
- TRANSITION FLASHING
- 1/8" - #43 POP RIVET (18" o.c.)
- Z-CLOSURE
- #10 - 13 x 1" PHW (5 PER PANEL)
- D.B. TAPE SEALANT
- PLYWOOD SUBSTRATE (1/2" MIN.)
- DMC 200S PANEL
- METSHIELD UNDERLAYMENT

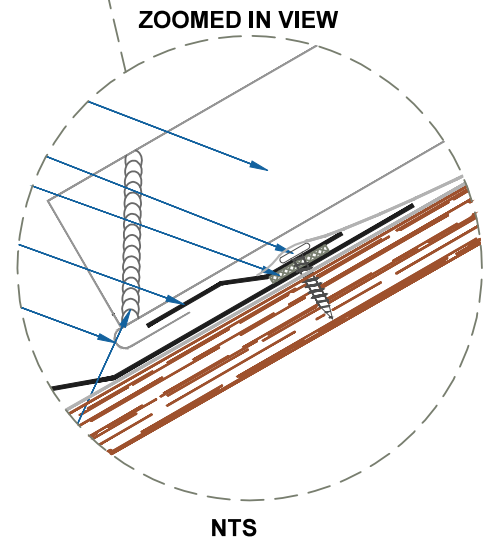
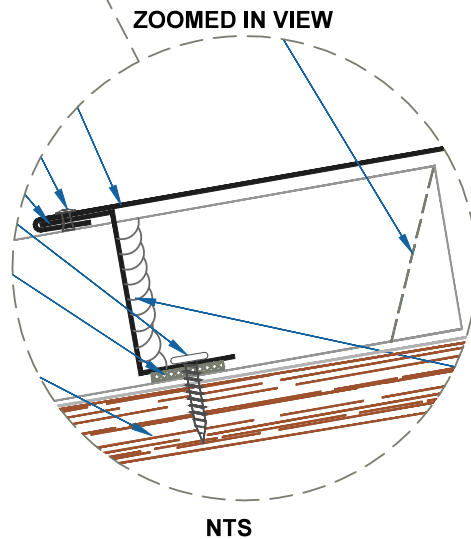
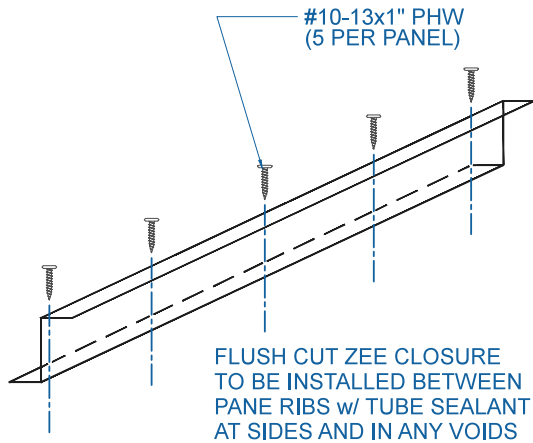
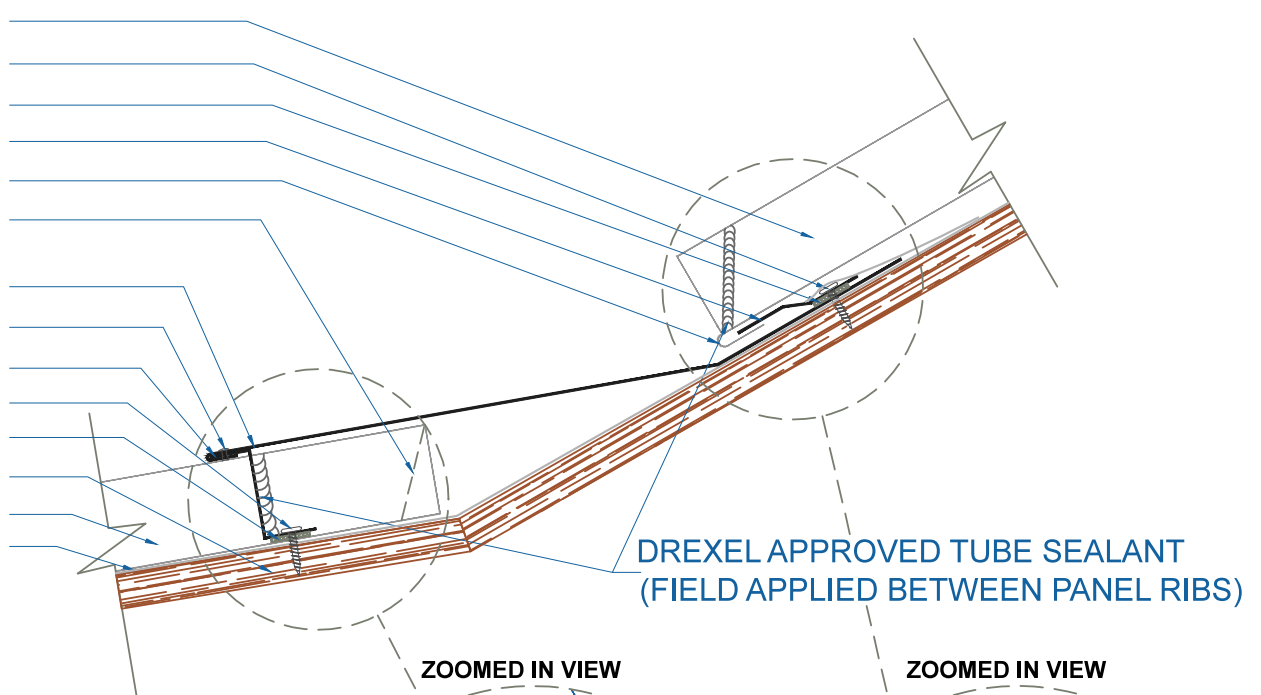

## TRANSITION

SCALE: 3" = 1'-0"

EFFECTIVE DATE: 12-11-12  
SUBJECT TO CHANGE WITHOUT NOTICE

# DMC 200S - PLYWOOD

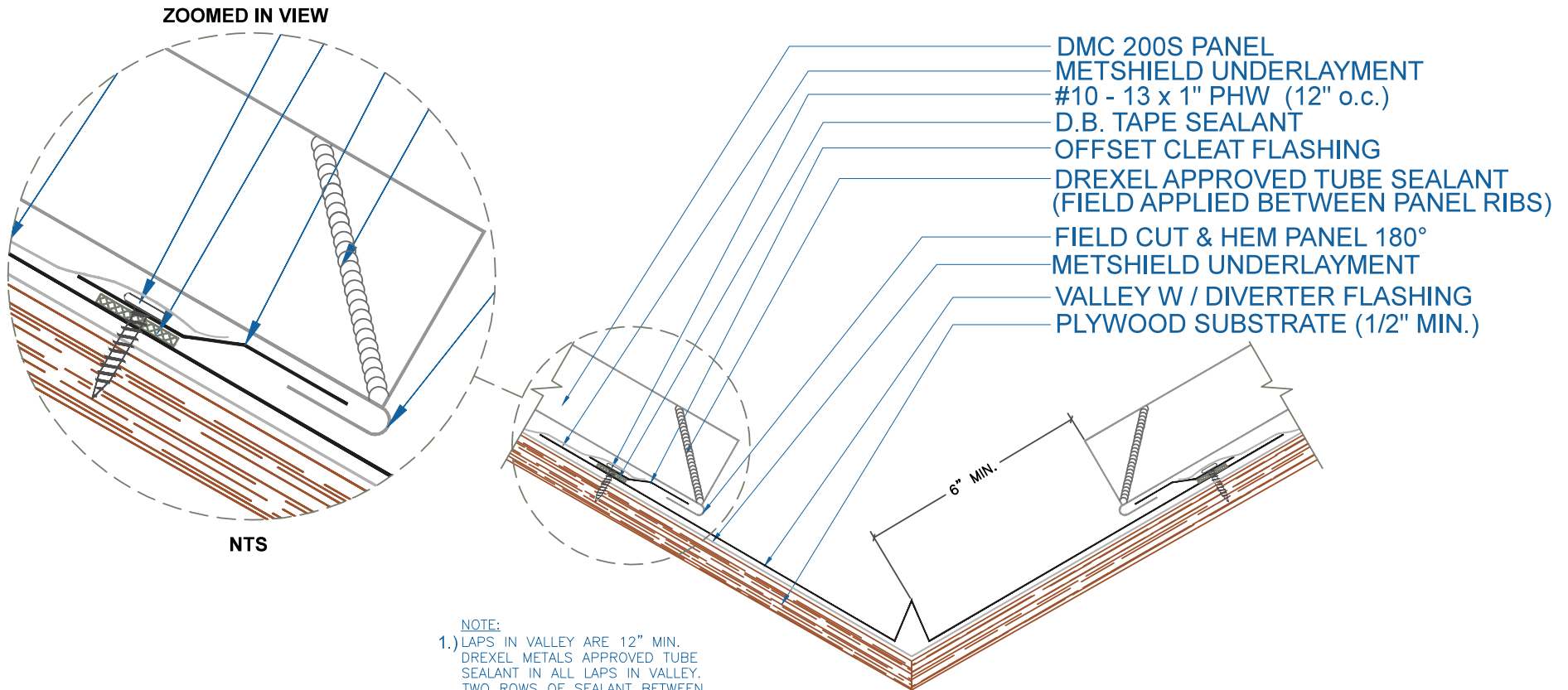

NTS

**NOTE:**

- 1.) LAPS IN VALLEY ARE 12" MIN. DREXEL METALS APPROVED TUBE SEALANT IN ALL LAPS IN VALLEY. TWO ROWS OF SEALANT BETWEEN VALLEY LAPS, 4" UP FROM LAP.
- 2.) LARGE ROOF AREAS MAY REQUIRE A LARGER GAP BETWEEN PANEL AND DIVERTER TO ALLOW FOR STORM WATER RUN OFF.

6" MIN.

## VALLEY W / DIVERTER

SCALE: 3" = 1'-0"



EFFECTIVE DATE: 12-11-12  
 SUBJECT TO CHANGE WITHOUT NOTICE

# DMC 200S - PLYWOOD

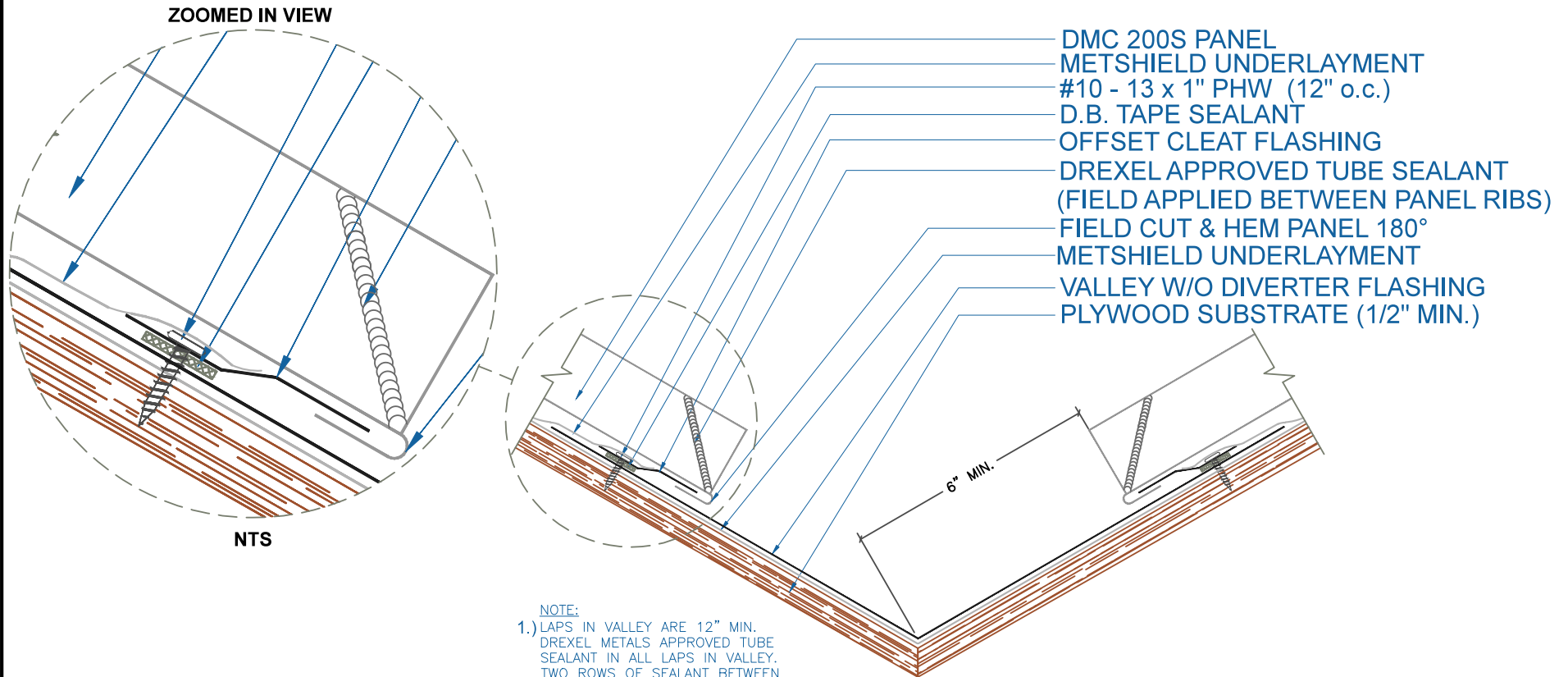

- NOTE:**
- 1.) LAPS IN VALLEY ARE 12" MIN. DREXEL METALS APPROVED TUBE SEALANT IN ALL LAPS IN VALLEY. TWO ROWS OF SEALANT BETWEEN VALLEY LAPS, 4" UP FROM LAP.
  - 2.) LARGE ROOF AREAS MAY REQUIRE A LARGER GAP BETWEEN PANEL AND DIVERTER TO ALLOW FOR STORM WATER RUN OFF.

## VALLEY W/O DIVERTER

SCALE: 3" = 1'-0"

EFFECTIVE DATE: 12-11-12  
 SUBJECT TO CHANGE WITHOUT NOTICE





# DMC 200S - PLYWOOD

- NOTE:**
- 1.) LAPS IN VALLEYWALL ARE 12" MIN. DREXEL METALS APPROVED SEALANT IN ALL LAPS IN VALLEY. TWO ROWS OF SEALANT BETWEEN VALLEYWALL LAPS, 4" UP FROM LAP.
  - 2.) LARGE ROOF AREAS MAY REQUIRE A LARGER GAP BETWEEN PANEL AND WALL TO ALLOW FOR STORM WATER RUN OFF.

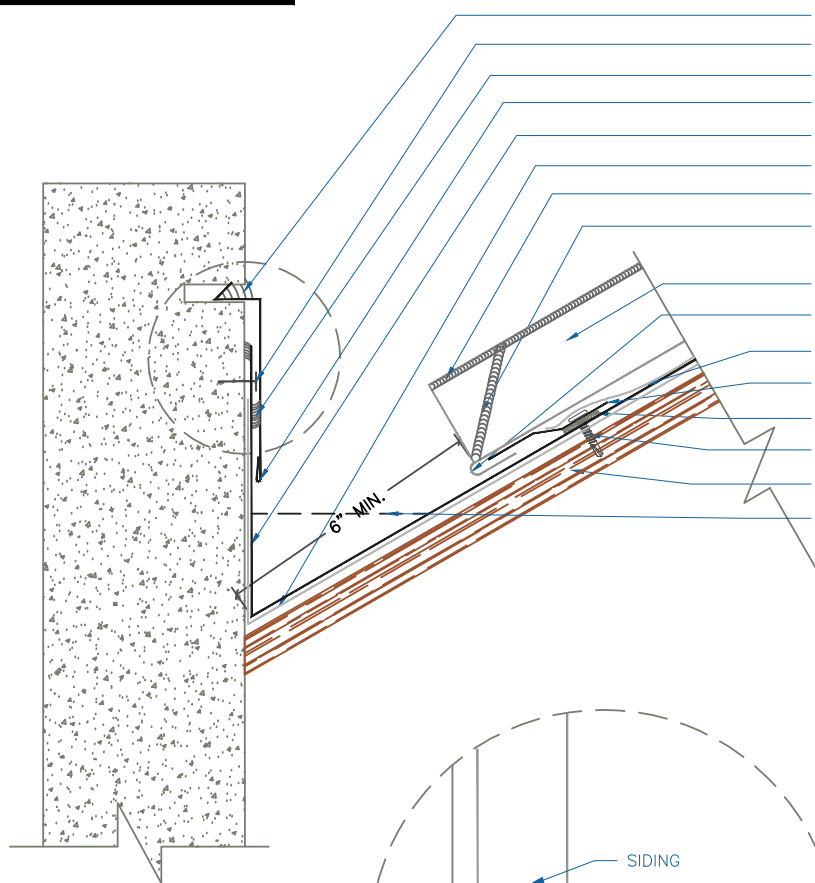

- DREXEL APPROVED TUBE SEALANT
- FASTENERS (BY OTHERS)
- DREXEL APPROVED TUBE SEALANT
- REGLET FLASHING
- VALLEYWALL FLASHING
- METSHIELD UNDERLAYMENT
- SEAM SEALANT (3'-0" UP FROM RIB END)
- DREXEL APPROVED TUBE SEALANT (FIELD APPLIED BETWEEN PANEL RIBS)
- DMC 200S PANEL
- FIELD CUT & HEM PANEL 180°
- METSHIELD UNDERLAYMENT
- OFFSET CLEAT FLASHING
- D.B. TAPE SEALANT
- #10 - 13 x 1" PHW (12" o.c.)
- PLYWOOD SUBSTRATE (1/2" MIN.)
- CRICKET BEYOND

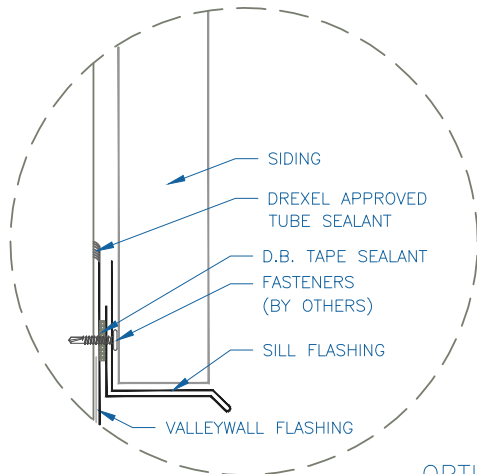

OPTION 1

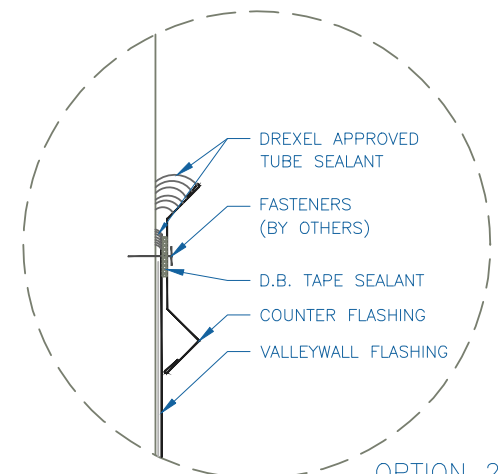

OPTION 2

EFFECTIVE DATE: 12-11-12  
 SUBJECT TO CHANGE WITHOUT NOTICE

**VALLEYWALL**  
 SCALE: 3" = 1'-0"



# DMC 200S - PLYWOOD

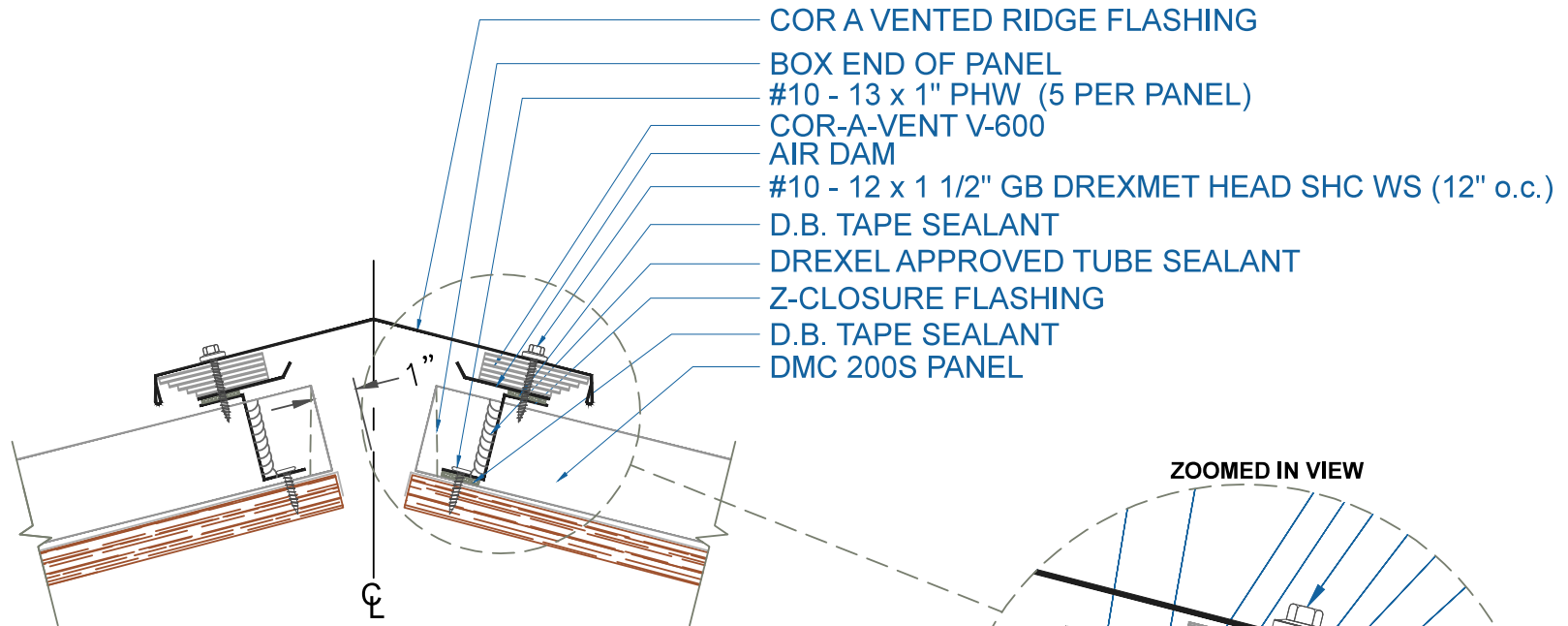

- COR A VENTED RIDGE FLASHING
- BOX END OF PANEL
- #10 - 13 x 1" PHW (5 PER PANEL)
- COR-A-VENT V-600
- AIR DAM
- #10 - 12 x 1 1/2" GB DREXMET HEAD SHC WS (12" o.c.)
- D.B. TAPE SEALANT
- DREXEL APPROVED TUBE SEALANT
- Z-CLOSURE FLASHING
- D.B. TAPE SEALANT
- DMC 200S PANEL

NOTE:  
1.) NET FREE AREA = 20 SQ IN/FT

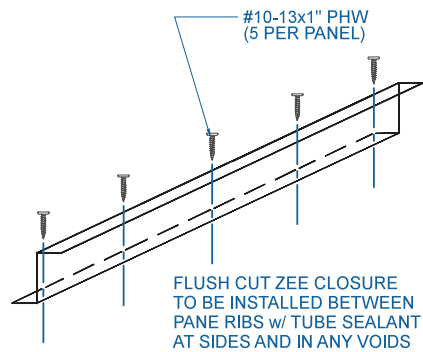

#10-13x1" PHW  
(5 PER PANEL)

FLUSH CUT ZEE CLOSURE  
TO BE INSTALLED BETWEEN  
PANE RIBS w/ TUBE SEALANT  
AT SIDES AND IN ANY VOIDS

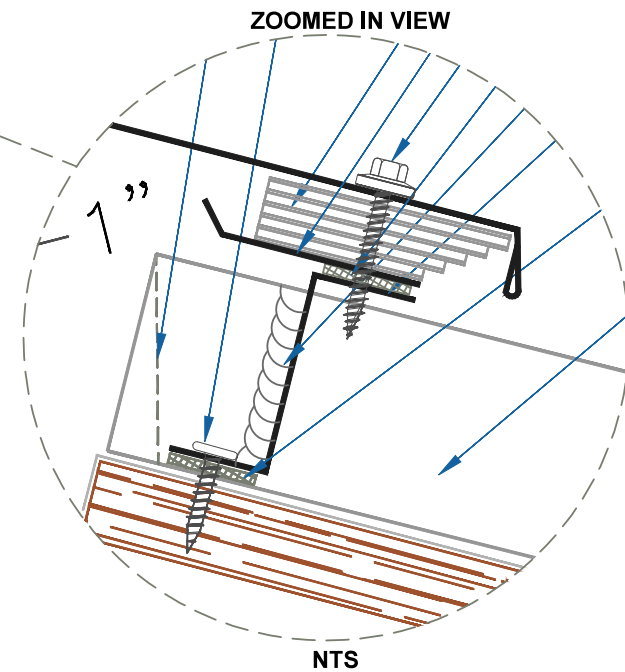

## COR-A-VENTED RIDGE / HIP

SCALE: 3" = 1'-0"

EFFECTIVE DATE: 1-9-13  
SUBJECT TO CHANGE WITHOUT NOTICE

# DMC 200S - PLYWOOD

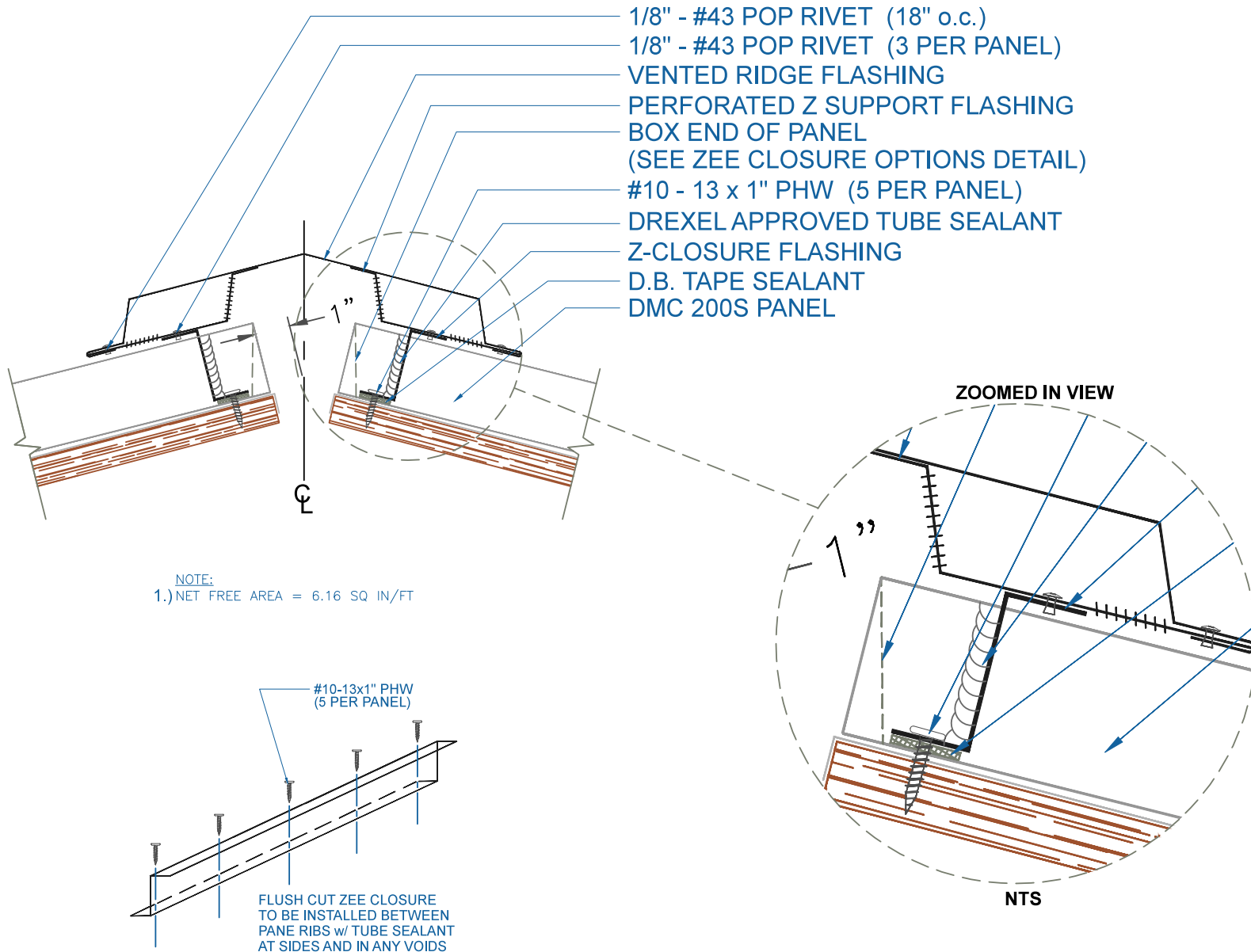

EFFECTIVE DATE: 12-11-12  
 SUBJECT TO CHANGE WITHOUT NOTICE

## VENTED RIDGE / HIP

SCALE: 3" = 1'-0"