

# DMC 150NS - PLYWOOD

ZOOMED IN VIEW

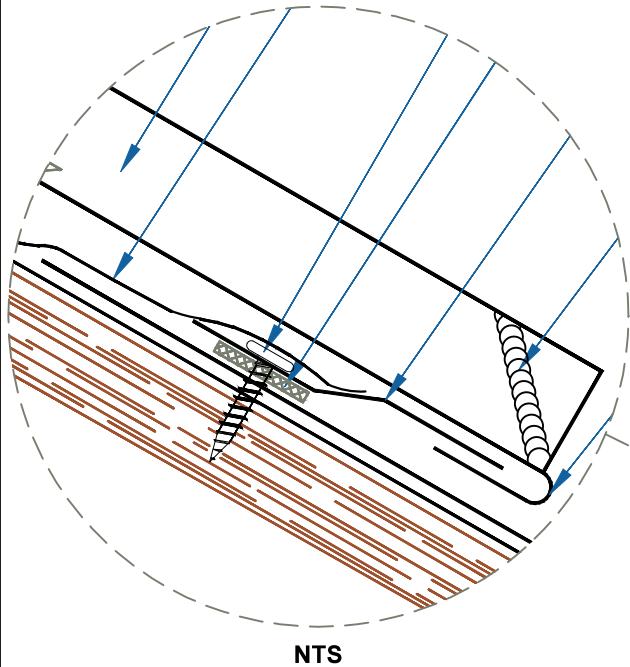

NTS

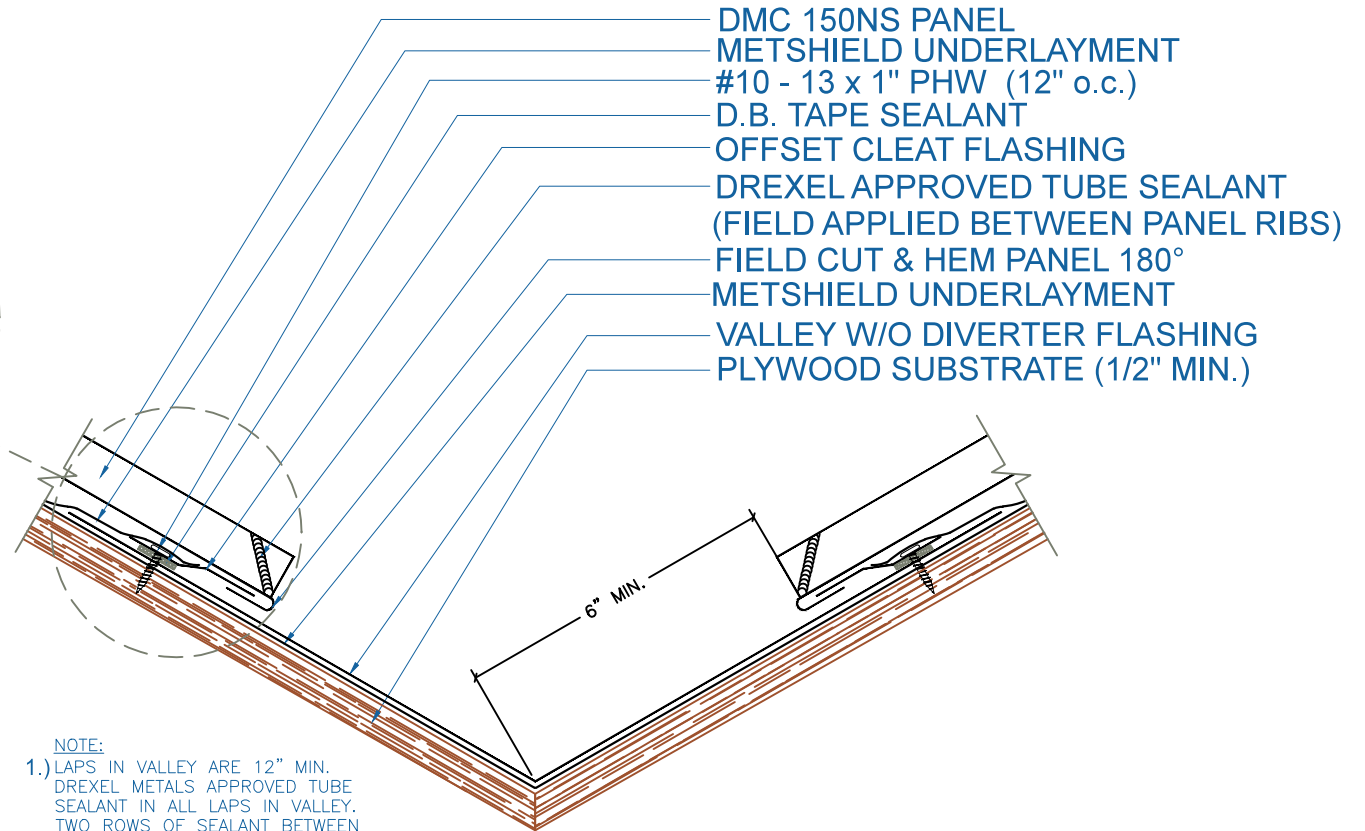

- DMC 150NS PANEL
- METSHIELD UNDERLAYMENT
- #10 - 13 x 1" PHW (12" o.c.)
- D.B. TAPE SEALANT
- OFFSET CLEAT FLASHING
- DREXEL APPROVED TUBE SEALANT  
(FIELD APPLIED BETWEEN PANEL RIBS)
- FIELD CUT & HEM PANEL 180°
- METSHIELD UNDERLAYMENT
- VALLEY W/O DIVERTER FLASHING
- PLYWOOD SUBSTRATE (1/2" MIN.)

**NOTE:**

- 1.) LAPS IN VALLEY ARE 12" MIN.  
DREXEL METALS APPROVED TUBE SEALANT IN ALL LAPS IN VALLEY.  
TWO ROWS OF SEALANT BETWEEN VALLEY LAPS, 4" UP FROM LAP.
- 2.) LARGE ROOF AREAS MAY REQUIRE A LARGER GAP BETWEEN PANEL AND DIVERTER TO ALLOW FOR STORM WATER RUN OFF.

## VALLEY W/O DIVERTER

SCALE: 3" = 1'-0"

EFFECTIVE DATE: 02-15-2013  
SUBJECT TO CHANGE WITHOUT NOTICE