

FASCIA EC PRINT APPROVAL

ANSI/SPRI ES-1 CERTIFIED -

.040"AL = XXX psf, 24GA = XXX psf (8 1/2" Max. Face/Top Fasteners Only)

.040"AL = XXX psf, 24GA = XXX psf (8 1/2" Max. Face)

.050"AL = XXX psf, 22GA = XXX psf (10" & 11 1/2" Face)

Cleat Part Number	"F" Dim.	"X" Dim.	Nailers Covered
EFC4	4"	3 9/16"	1
EFC5.5	5 1/2"	5 1/16"	2
EFC7	7"	6 9/16"	3
EFC8.5	8 1/2"	8 1/16"	4
EFC10	10"	9 9/16"	5
EFC11.5	11 1/2"	11 1/16"	6

Maximum tested Face Height "F" for .040" AL and 24GA Steel is 8 1/2".

Face Height "F" of 10" and 11 1/2" require .050" AL or 22GA Steel.

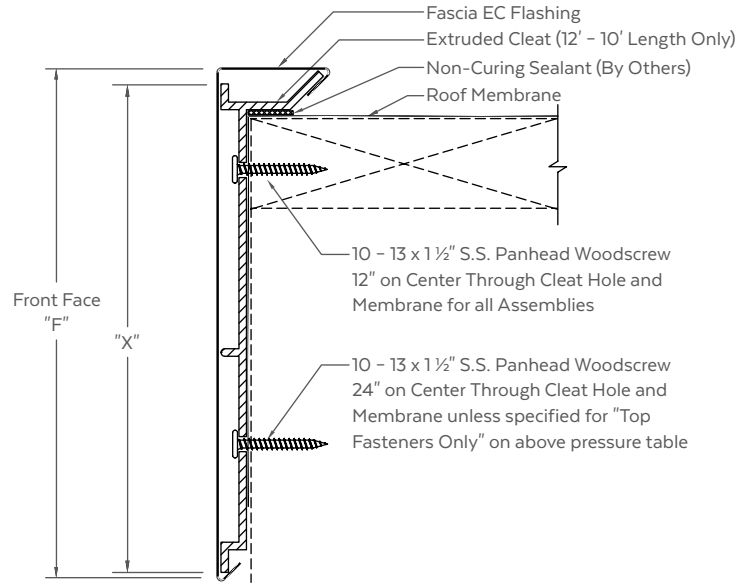

MATERIAL

24GA .040" AL

22GA .050" AL

Other: .063" AL

Finish: _____

Color: _____

QUANTITIES

Lineal Feet (10'-0" Lengths): _____

Outside Miters*: _____ Optional Welded (Surcharge Applies)

Inside Miters*: _____ Optional Welded (Surcharge Applies)

Right End Caps*: _____ Optional Welded (Surcharge Applies)

Left End Caps*: _____ Optional Welded (Surcharge Applies)

* Standard riveted

PROJECT DETAILS

Project: _____

Architect: _____

Roofing Contractor: _____

Representative: _____

PRINT APPROVAL

Architect and/or Contractor shall verify all dimensions, sizes, and quantities, All products to be installed in strict accordance with Drexel's printed instructions.

Effective Date: _____

Drawn By: _____

Approved By: _____