

DMC 450SL - PLYWOOD

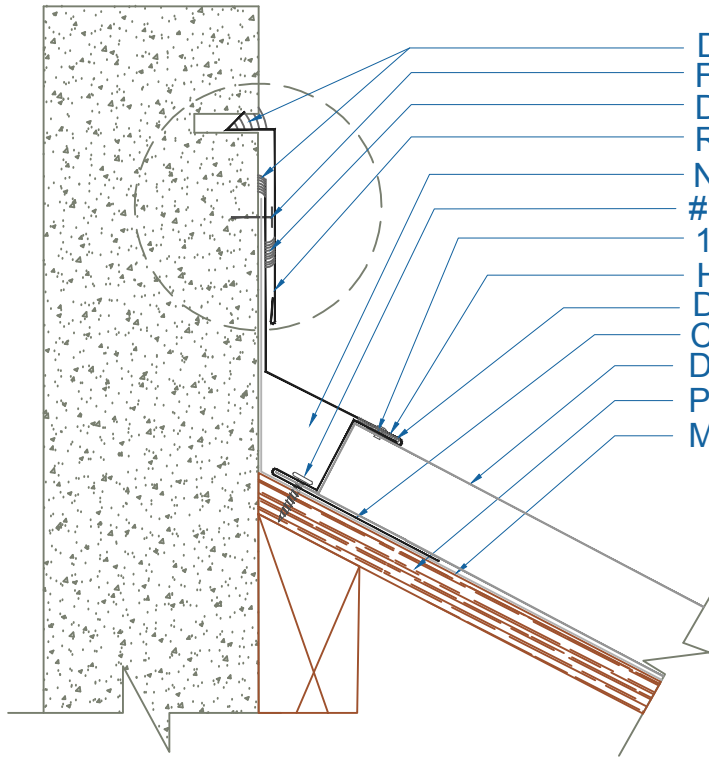

- DREXEL APPROVED TUBE SEALANT
- FASTENERS (BY OTHERS)
- DREXEL APPROVED TUBE SEALANT
- REGLET FLASHING
- NOTCH END OF PANEL
- #10 - 13 x 1" PHW (5 PER PANEL)
- 1/8" - #43 POP RIVET (18" O.C.)
- HEADWALL FLASHING
- DREXEL APPROVED TUBE SEALANT
- CFR FLASHING
- DMC 450SL PANEL
- PLYWOOD SUBSTRATE (1/2" MIN.)
- METSHIELD UNDERLAYMENT

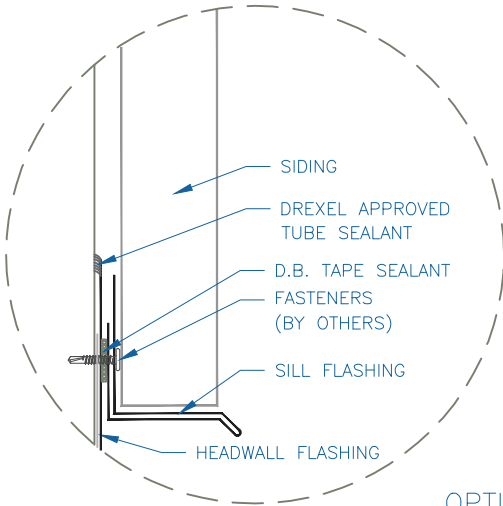

OPTION 1

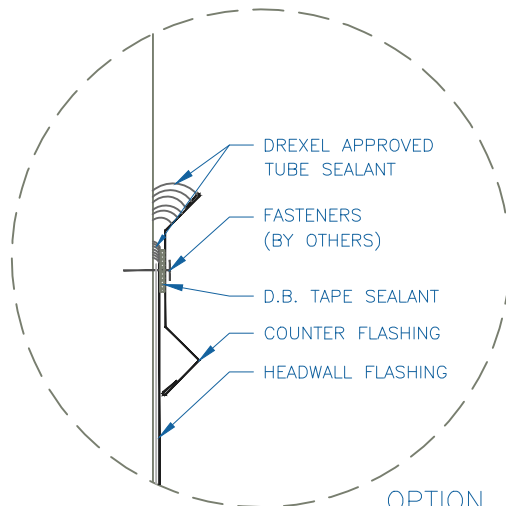

OPTION 2

