

# DMC 450SL - SOLID SUBSTRATE

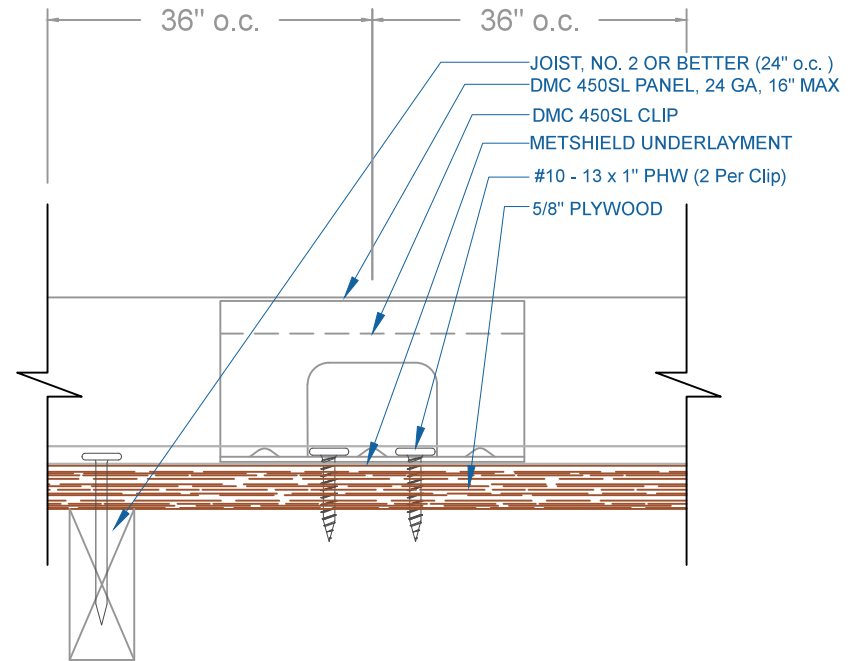
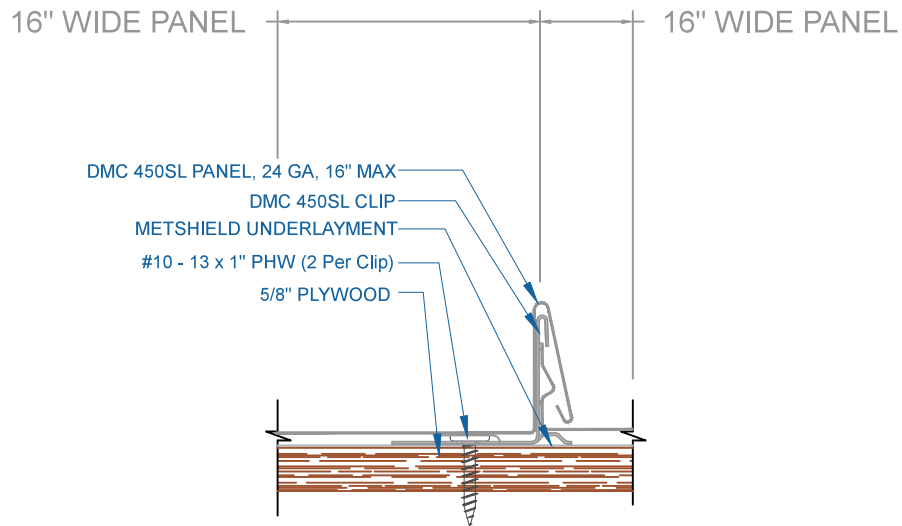

## INSTALLATION

SCALE: NTS  
EFFECTIVE DATE: 09-13-13

# DMC 450SL - PLYWOOD

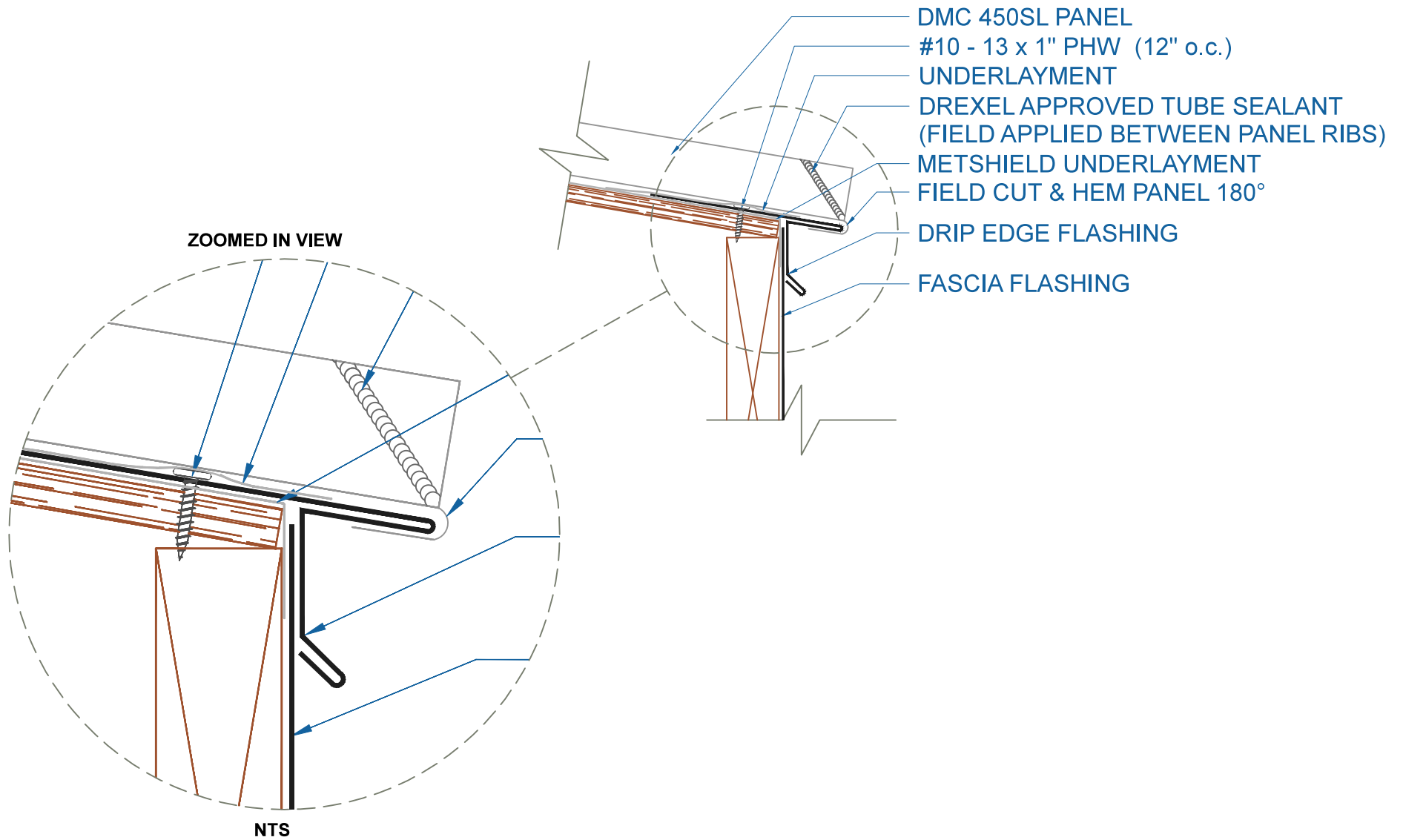

EFFECTIVE DATE: 01-06-14  
SUBJECT TO CHANGE WITHOUT NOTICE

## DRIP EDGE

SCALE: 3" = 1'-0"



# DMC 450SL - PLYWOOD

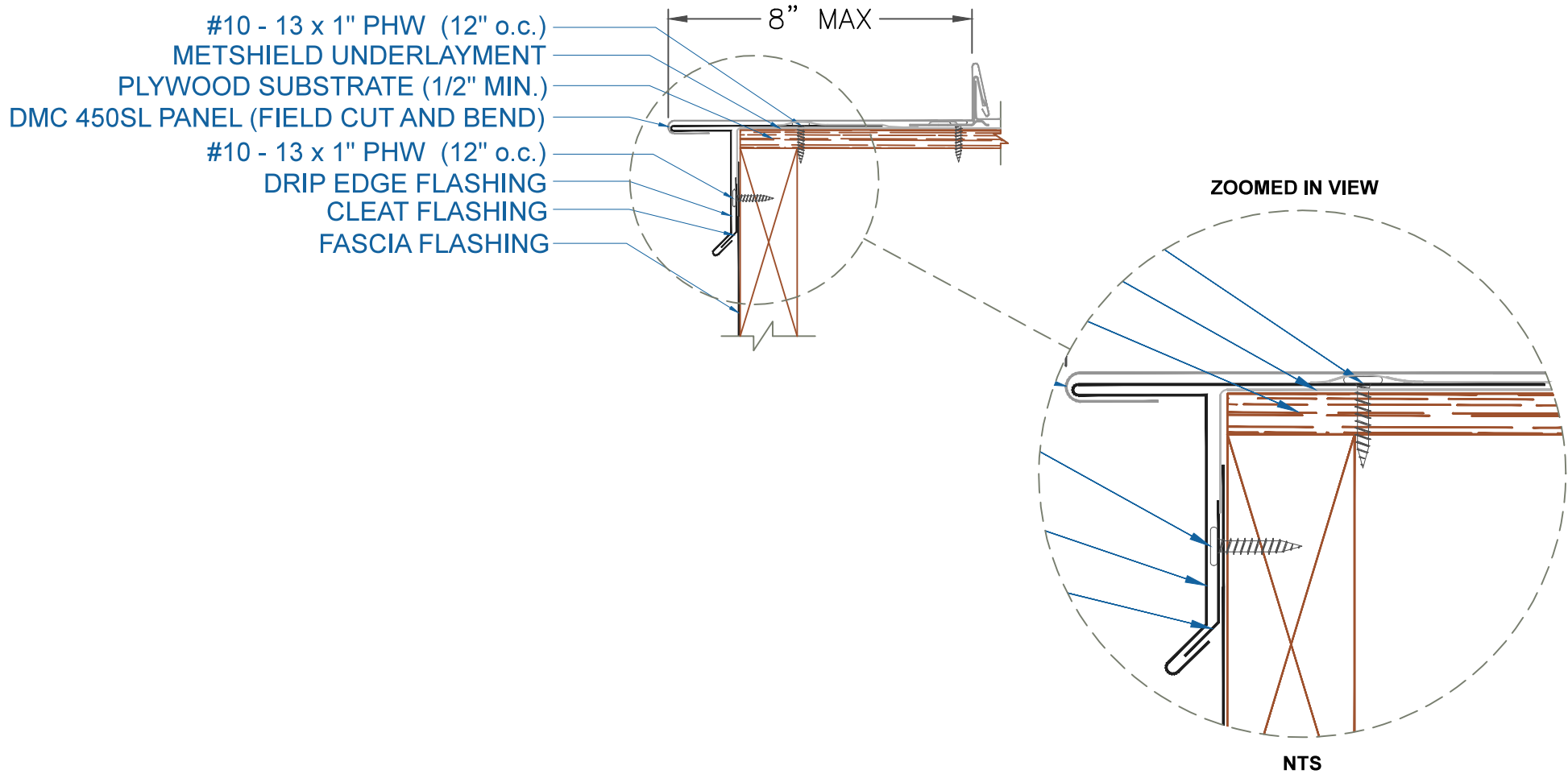

## GABLE ALTERNATE / CURVED

SCALE: 3" = 1'-0"

EFFECTIVE DATE: 01-06-14  
SUBJECT TO CHANGE WITHOUT NOTICE



# DMC 450SL - PLYWOOD

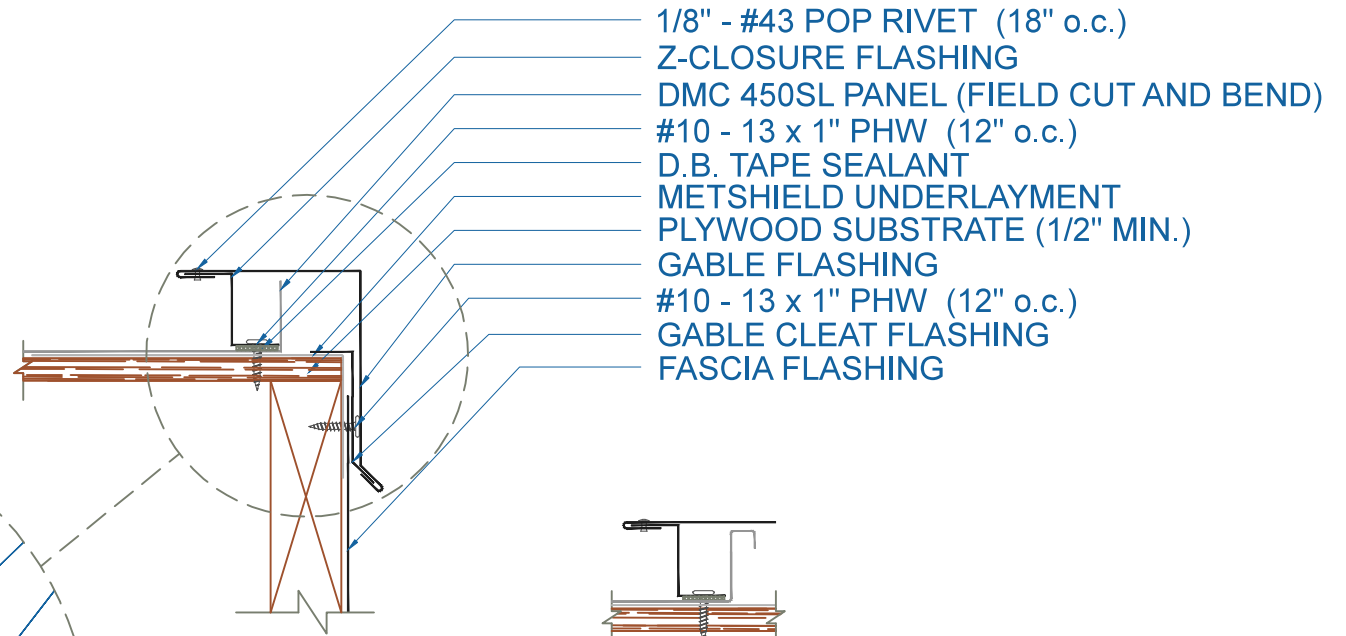

ZOOMED IN VIEW

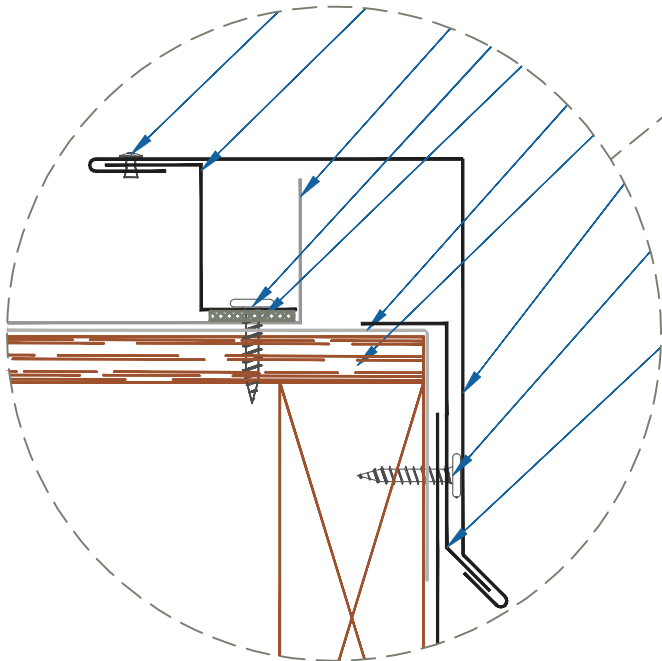

NTS

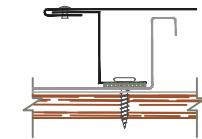

ON MODULE

EFFECTIVE DATE: 01-06-14  
 SUBJECT TO CHANGE WITHOUT NOTICE

**GABLE**

SCALE: 3" = 1'-0"

# DMC 450SL - PLYWOOD

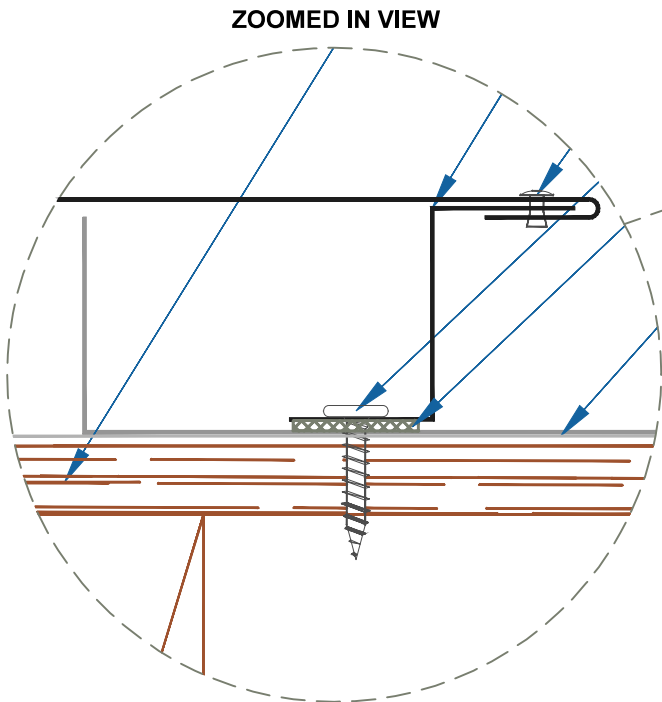
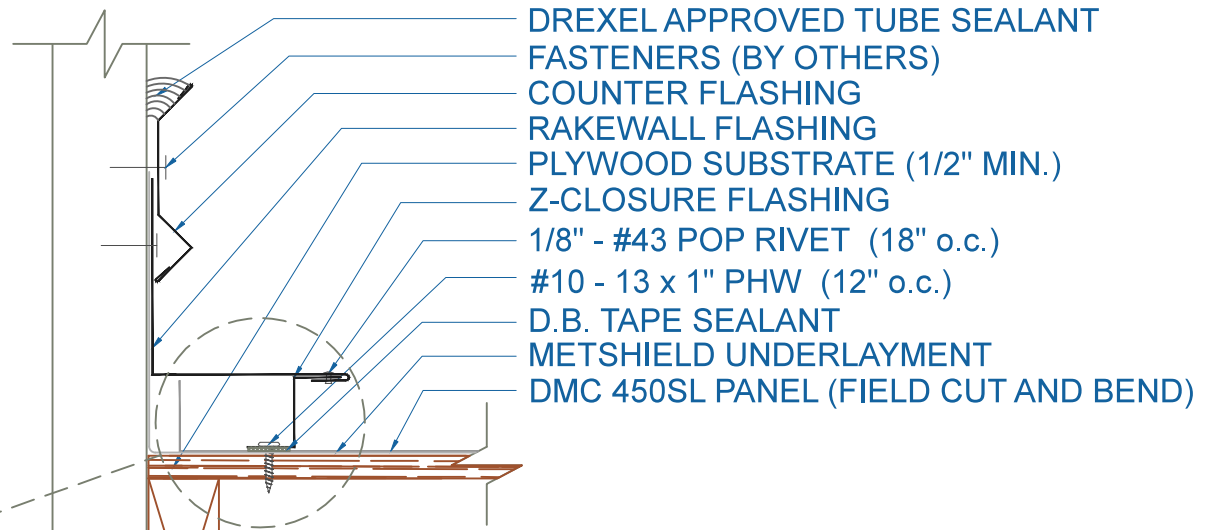

NTS

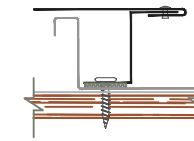

ON MODULE

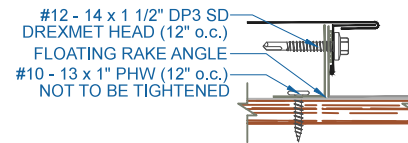

FLOATING RAKEWALL

EFFECTIVE DATE: 01-06-14  
 SUBJECT TO CHANGE WITHOUT NOTICE

## RAKEWALL

SCALE: 3" = 1'-0"

# DMC 450SL - PLYWOOD

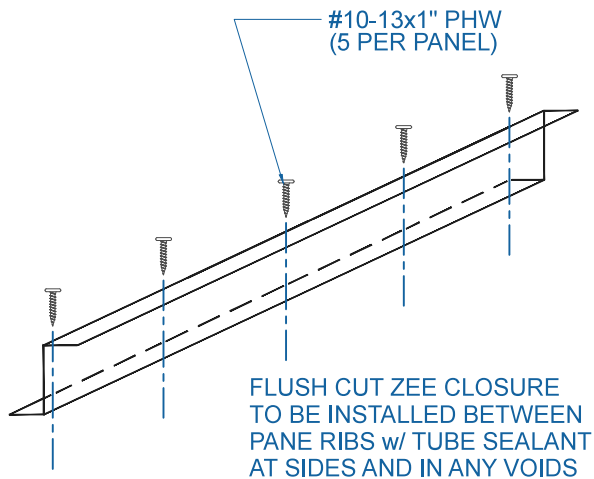
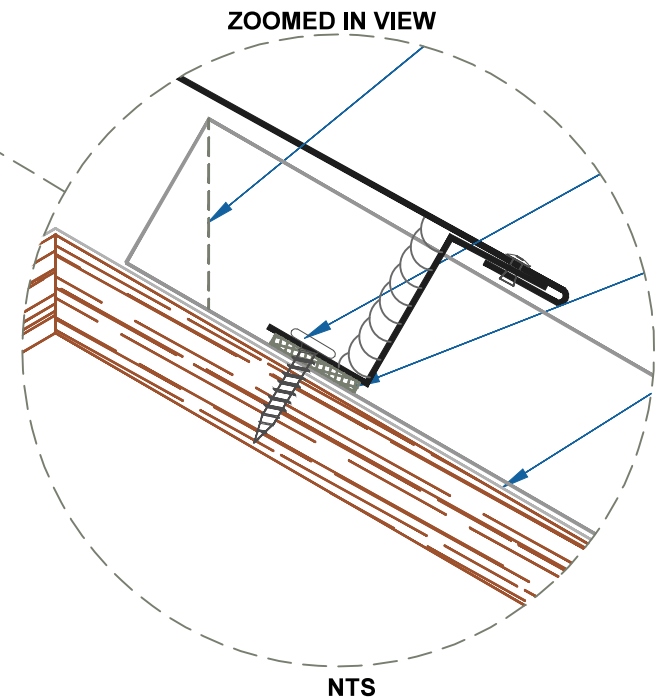
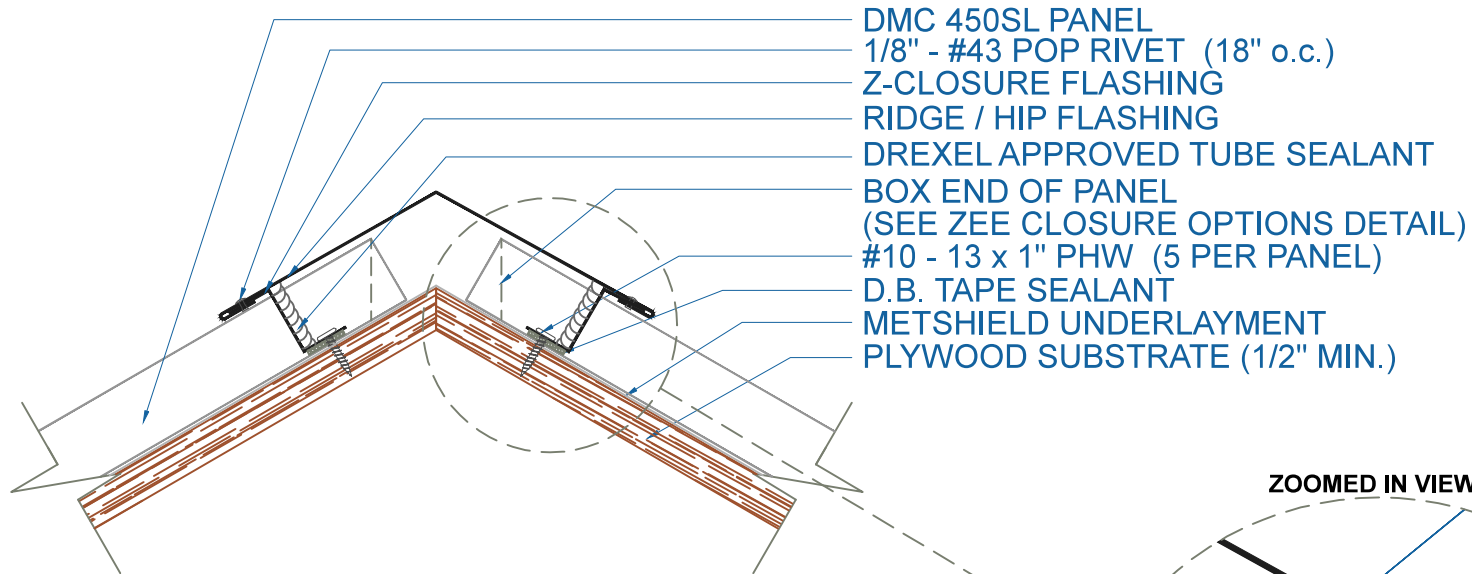

EFFECTIVE DATE: 01-06-14  
SUBJECT TO CHANGE WITHOUT NOTICE

## RIDGE / HIP

SCALE: 3" = 1'-0"

**DrexelMetals**  
Roofing Systems + Custom Fabrication

