

DMC 450 - PLYWOOD

ZOOMED IN VIEW

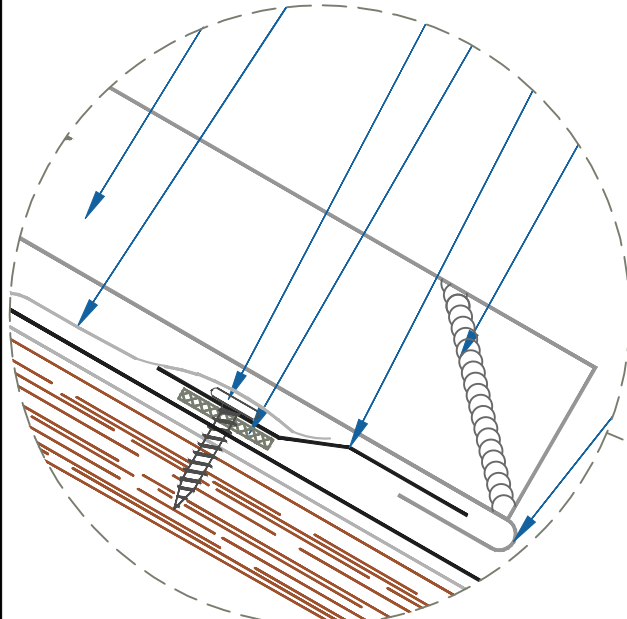

NTS

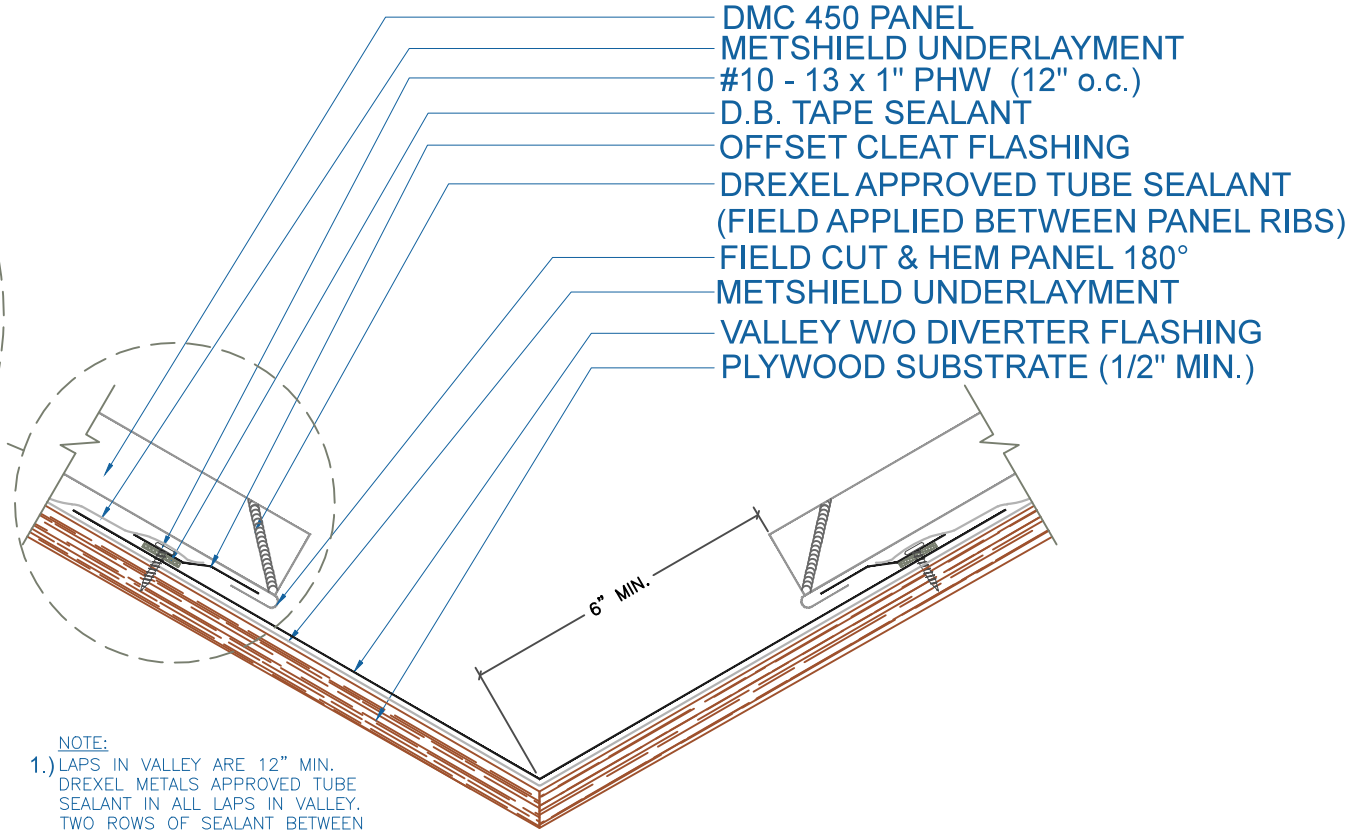

- NOTE:
- 1.) LAPS IN VALLEY ARE 12" MIN.
DREXEL METALS APPROVED TUBE SEALANT IN ALL LAPS IN VALLEY.
TWO ROWS OF SEALANT BETWEEN VALLEY LAPS, 4" UP FROM LAP.
 - 2.) LARGE ROOF AREAS MAY REQUIRE A LARGER GAP BETWEEN PANEL AND DIVERTER TO ALLOW FOR STORM WATER RUN OFF.

VALLEY W/O DIVERTER



EFFECTIVE DATE: 01-06-14
SUBJECT TO CHANGE WITHOUT NOTICE

SCALE: 3" = 1'-0"