

# DMC 150SL - PLYWOOD

ZOOMED IN VIEW

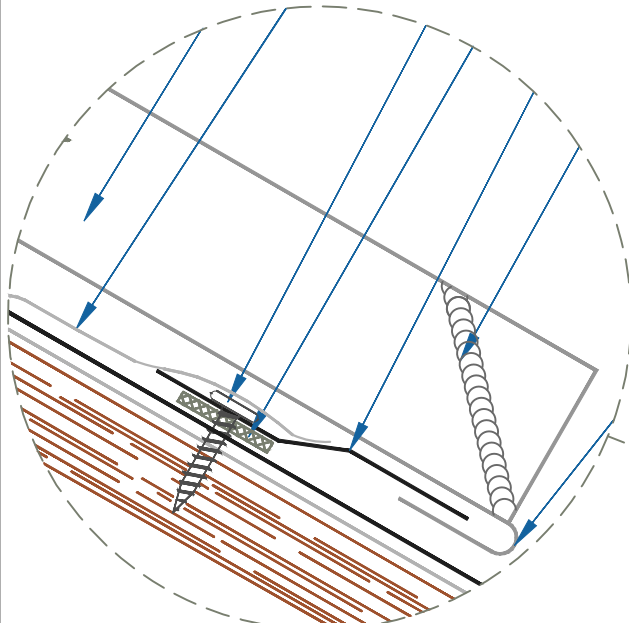

NTS

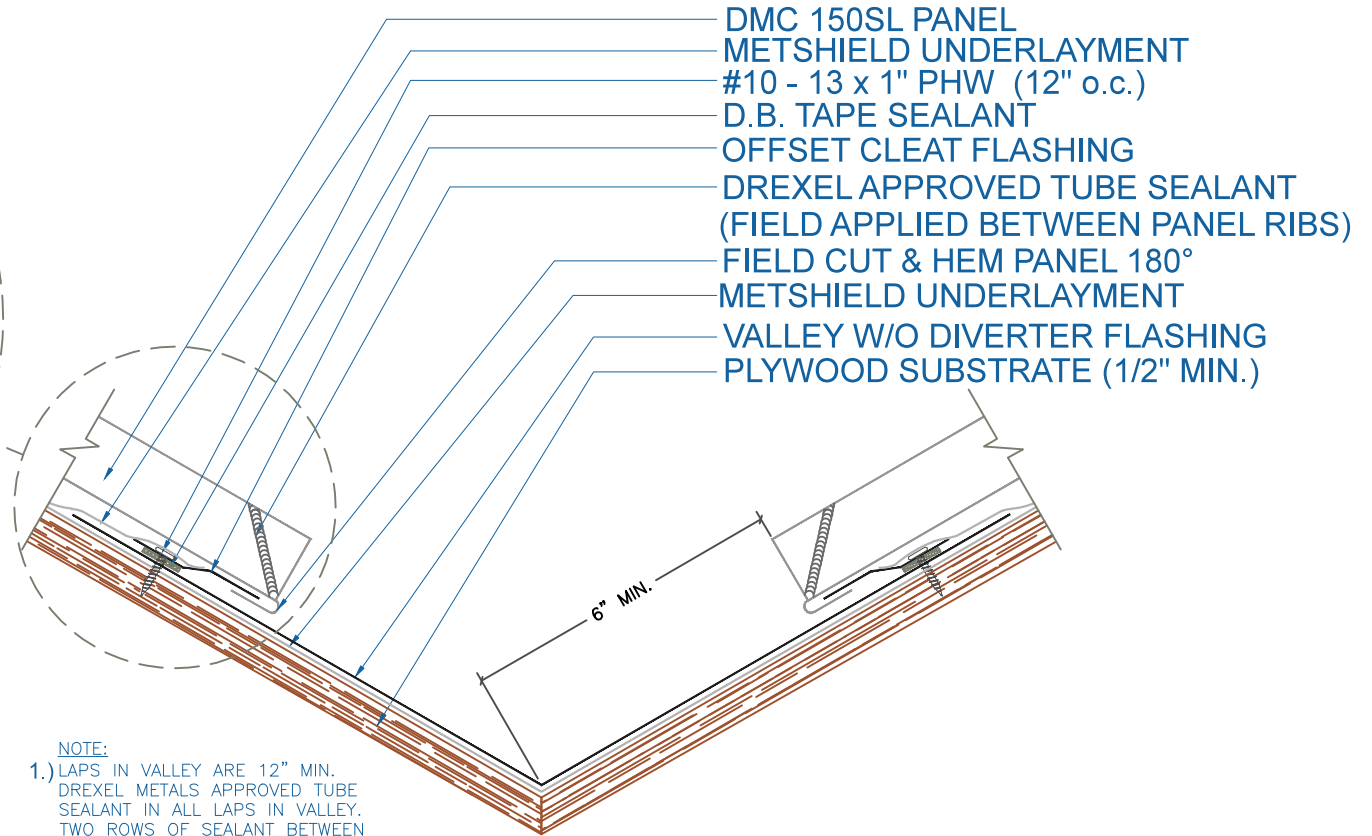

NOTE:

- 1.) LAPS IN VALLEY ARE 12" MIN.  
DREXEL METALS APPROVED TUBE SEALANT IN ALL LAPS IN VALLEY.  
TWO ROWS OF SEALANT BETWEEN VALLEY LAPS, 4" UP FROM LAP.
- 2.) LARGE ROOF AREAS MAY REQUIRE A LARGER GAP BETWEEN PANEL AND DIVERTER TO ALLOW FOR STORM WATER RUN OFF.

## VALLEY W/O DIVERTER



EFFECTIVE DATE: 02-01-13  
SUBJECT TO CHANGE WITHOUT NOTICE

SCALE: 3" = 1'-0"